

MegaShore Support System Technical Info



F FORMTECH
concrete forms, inc.

 **Concrete**
Support Systems

Components

Mega Props

Prop Endplate

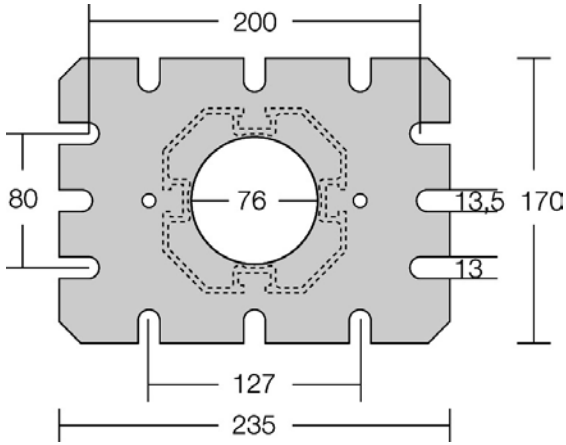

Mega Prop # 2

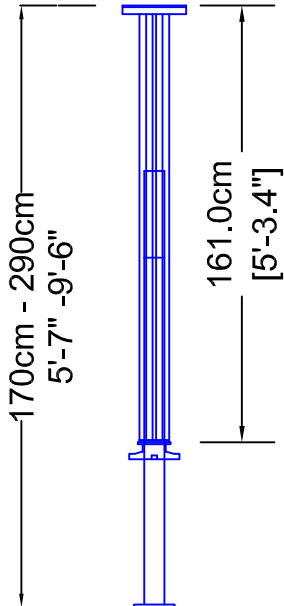

Mega Prop # 4

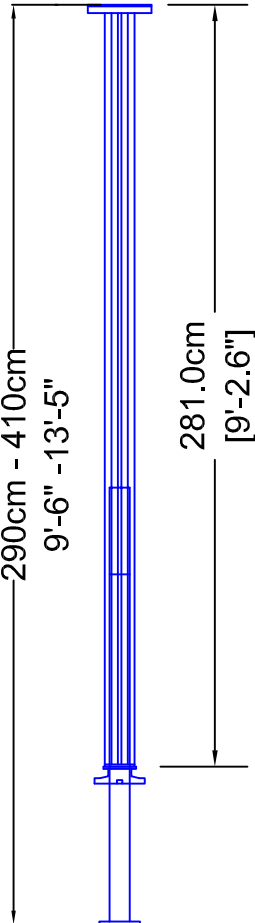

Mega Prop # 6

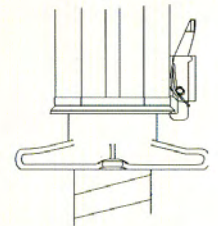
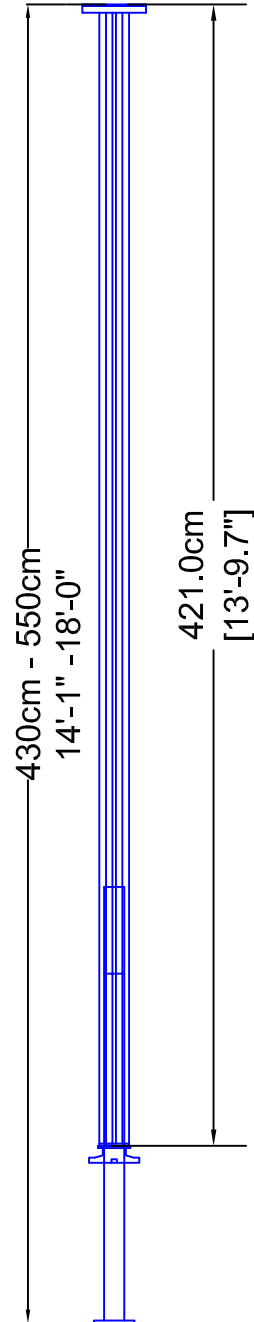

RETAINER CLIP

Code No.	Description	Height Range		Weight	
		cm	ft-in	Kg	lbs
0102-0742-000002	Mega Prop # 2	170cm-290cm	5'-7" - 9'-6"	18.00 Kg	39.7 lbs
0102-0742-000004	Mega Prop # 4	290cm-410cm	9'-6" - 13'-5"	23.00 Kg	50.7 lbs
0102-0742-000006	Mega Prop # 6	430cm-550cm	14'-1" - 18'	29.00 Kg	63.9 lbs

Components

Mega Outer Ext

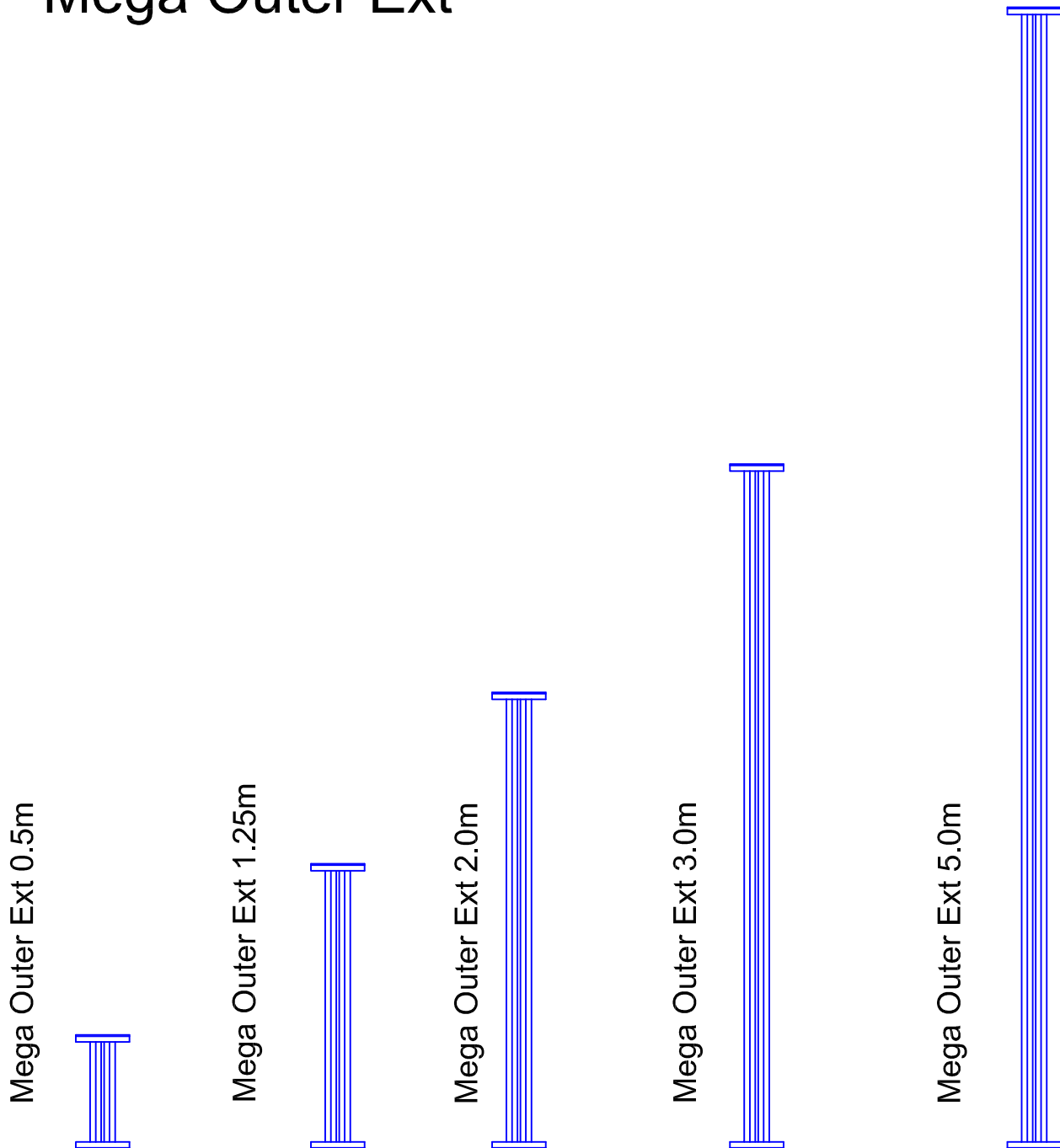

Code No.	Description	Length	Weight	
0102-0744-000050	Mega Outer Ext 0.5m	20"	3.50 Kg	7.7 lbs
0102-0744-000125	Mega Outer Ext 1.25m	49"	8.50 Kg	18.7 lbs
0102-0744-000200	Mega Outer Ext 2.00m	6'-6.75"	12.50 Kg	27.6 lbs
0102-0744-000300	Mega Outer Ext 3.00m	9'-10"	18.50 Kg	40.8 lbs
0102-0744-000500	Mega Outer Ext 5.00m	16'-5"	24.00 Kg	52.9 lbs

Components

Mega Jacks

Jack Endplate

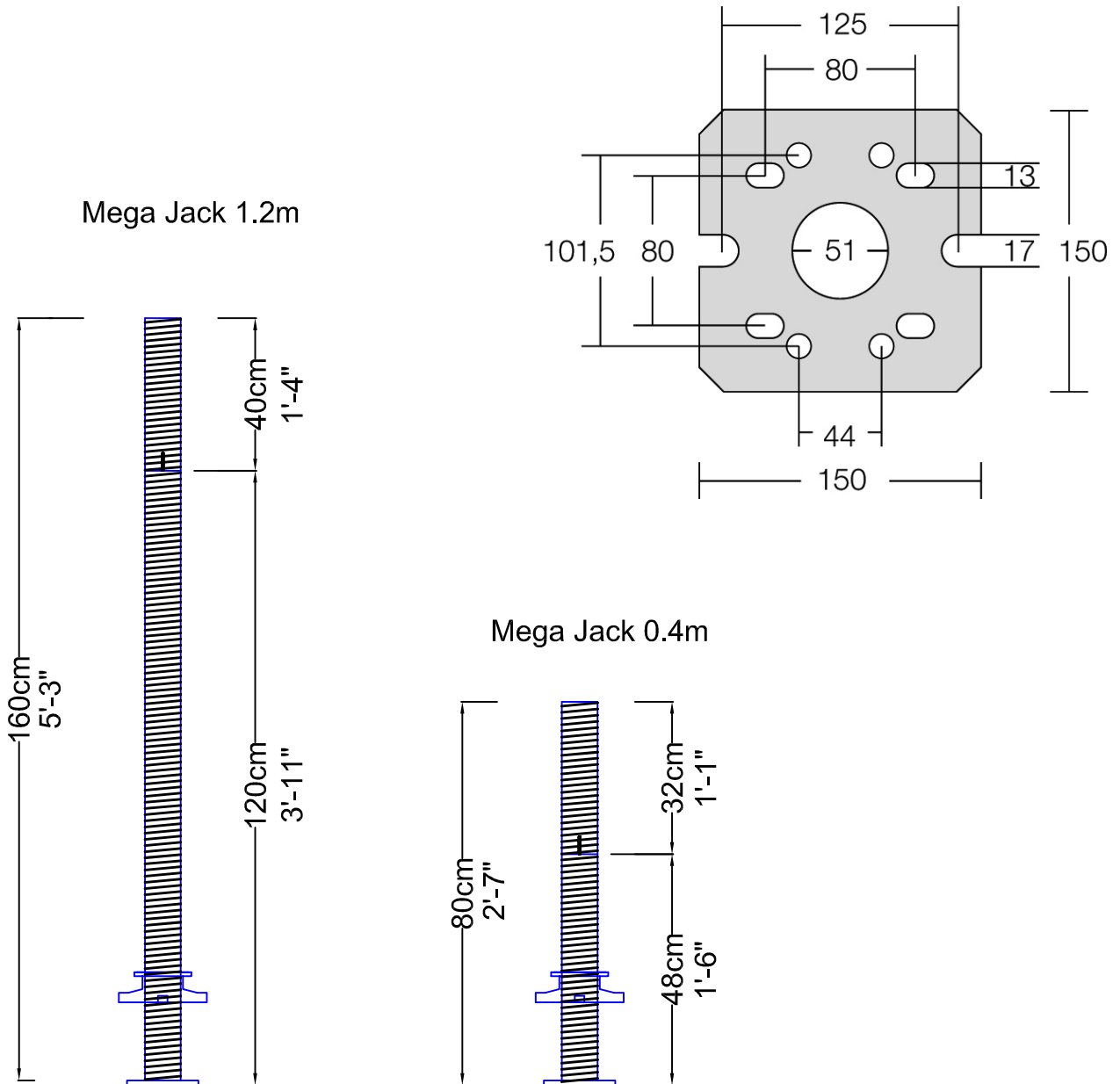

Code No.	Description	Length	Weight	Weight
0102-0743-000120	Mega Jack 1.2m	4'	10.40 Kg	22.9 lbs
0102-0743-000040	Mega Jack 0.4m	16"	7.00 Kg	15.4 lbs

Components

Mega Frames

The Mega Frame length is from Spindelleg center to Spindelleg center

The Ledger Frame height is 33"

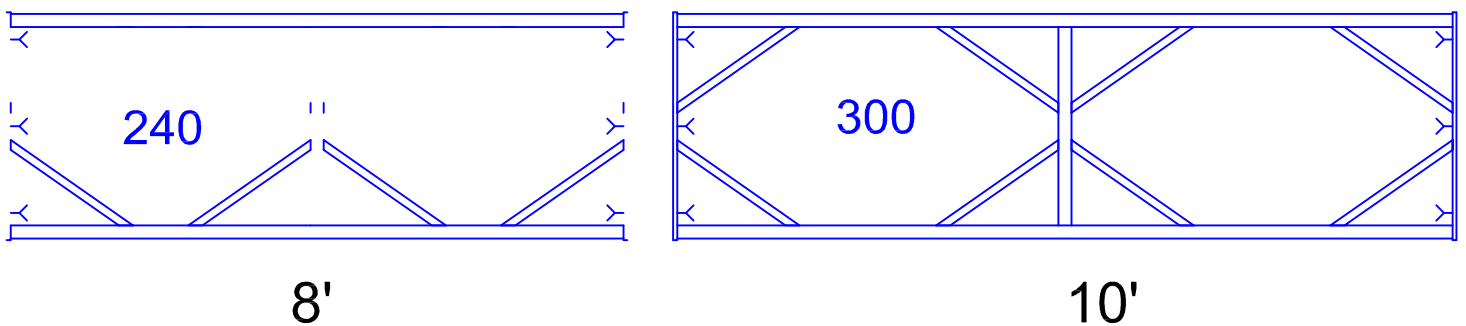
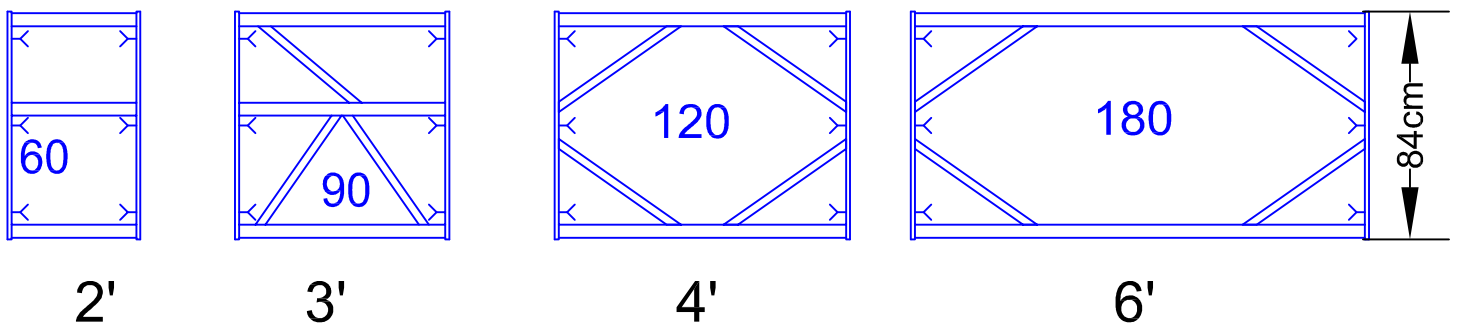

Code No.	Description	Center to Center	Weight	Weight
0102-0745-000060	Mega Frame 0.6m	1'-11 5/8"	5.90 Kg	13.0 lbs
0102-0745-000090	Mega Frame 0.9m	2'-11 3/8"	7.20 Kg	15.8 lbs
0102-0745-000120	Mega Frame 1.2m	3'-11 2/8"	6.70 Kg	14.8 lbs
0102-0745-000180	Mega Frame 1.8m	5'-10 7/8"	10.20 Kg	22.5 lbs
0102-0745-000240	Mega Frame 2.4m	7'-10 4/8"	13.50 Kg	29.8 lbs
0102-0745-000300	Mega Frame 3.0m	9'-10 1/8"	15.90 Kg	35.0 lbs

Components

Mega Alum Beam 225

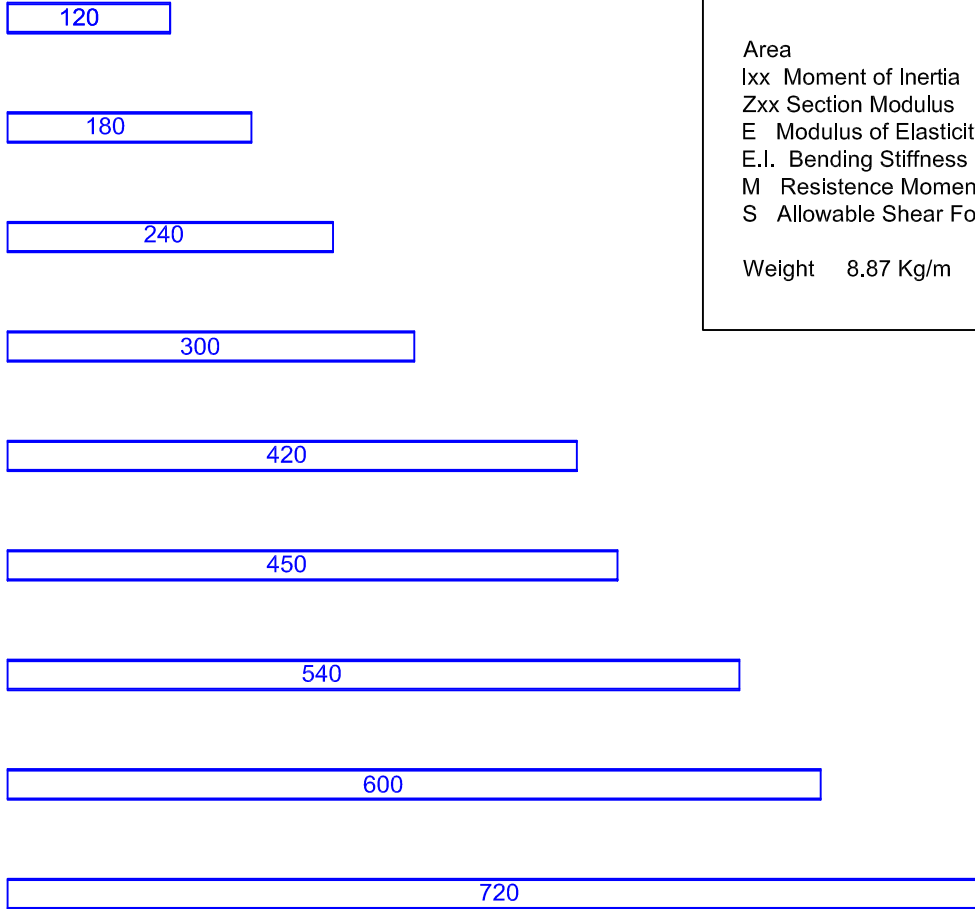

Area	32.63 cm ²	5,057 in ²
I _{xx} Moment of Inertia	2,241.00 cm ⁴	54.0 in ⁴
Z _{xx} Section Modulus	199.20 cm ³	12.16 in ³
E Modulus of Elasticity	68,900.00 N/mm ²	9,799,883 lbs/in ²
E.I. Bending Stiffness	1,544.00 KN/m ²	31,623 lbs/ft ²
M Resistance Moment	28.50 KNm	21,020 lb·ft
S Allowable Shear Force	89.00 KN	20,000 lbs
Weight	8.87 Kg/m	5.94 lbs/ft

Code No.	Description	Length	Weight	Weight
0102-0746-000120	Mega Alum Beam 225 x 1.2m	3'-11 1/4"	10.20 Kg	22.5 lbs
0102-0746-000180	Mega Alum Beam 225 x 1.8m	5'-10 7/8"	12.75 Kg	28.1 lbs
0102-0746-000240	Mega Alum Beam 225 x 2.4m	7'-10 1/2"	20.40 Kg	45.0 lbs
0102-0746-000300	Mega Alum Beam 225 x 3.0m	9'-10 1/8"	25.50 Kg	56.2 lbs
0102-0746-000420	Mega Alum Beam 225 x 4.2m	13'-9 3/8"	35.70 Kg	78.7 lbs
0102-0746-000450	Mega Alum Beam 225 x 4.5m	14'-9 3/8"	38.25 Kg	84.3 lbs
0102-0746-000540	Mega Alum Beam 225 x 5.4m	17'-8 5/8"	45.90 Kg	101.2 lbs
0102-0746-000600	Mega Alum Beam 225 x 6.0m	19'-8 1/4"	51.00 Kg	112.5 lbs
0102-0746-000720	Mega Alum Beam 225 x 7.2m	23'-7 1/2"	61.20 Kg	135.0 lbs

Components

AH20 Timber Girder

Technical Information

Maximum Bending Moment $M= 5,532 \text{ lbs}\cdot\text{ft}$
 Maximum Shear Force $Q= 3,710 \text{ lbs}$
 Weight 3.75 lbs/ft

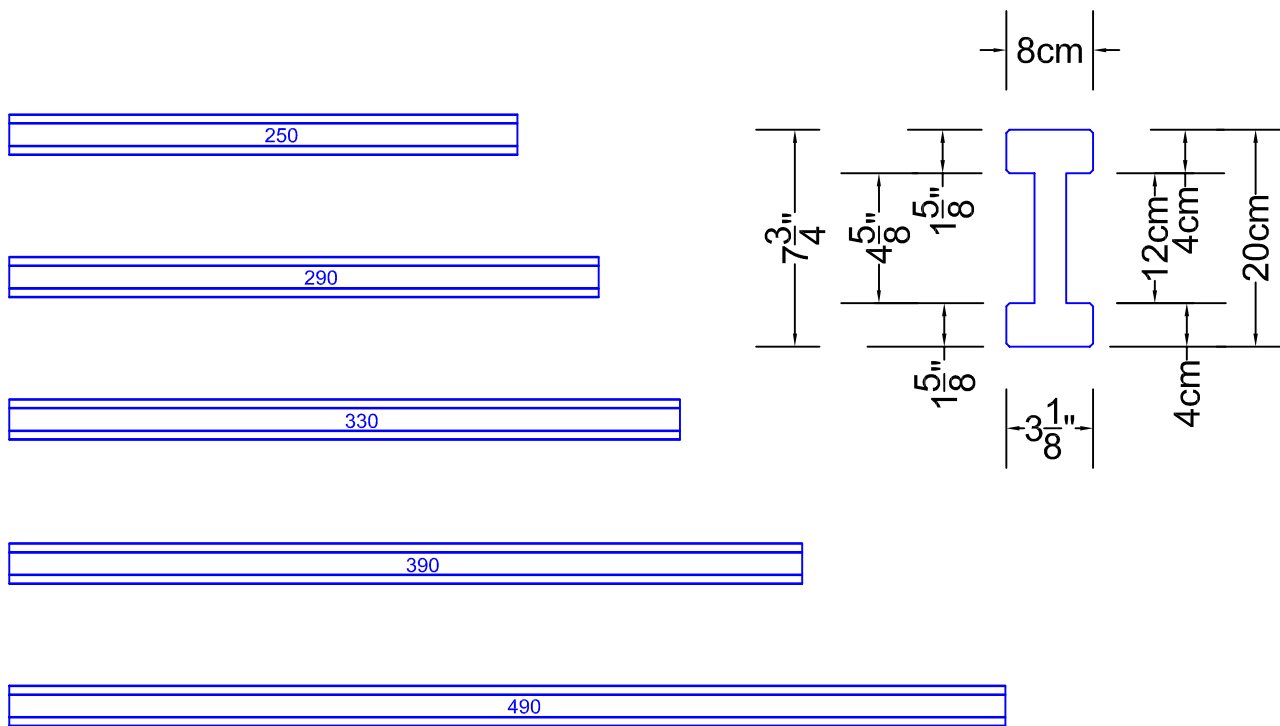

Code No.	Description	Length	Weight	Weight
0102-0641-000250	Girder AH20 x 2.5m	8'-2 3/8"	13.95 Kg	30.8 lbs
0102-0641-000290	Girder AH20 x 2.9m	9'-6 1/8"	16.20 Kg	35.9 lbs
0102-0641-000330	Girder AH20 x 3.3m	10'-10"	18.40 Kg	40.9 lbs
0102-0641-000390	Girder AH20 x 3.9m	12'-9 1/2"	21.70 Kg	48.2 lbs
0102-0641-000490	Girder AH20 x 4.9m	16'-1"	27.35 kg	60.30 lbs

Components

Mega Splice Plate



Used to splice two AluBeam 225 together. Use two plates per connection

Mega Connection Bracket

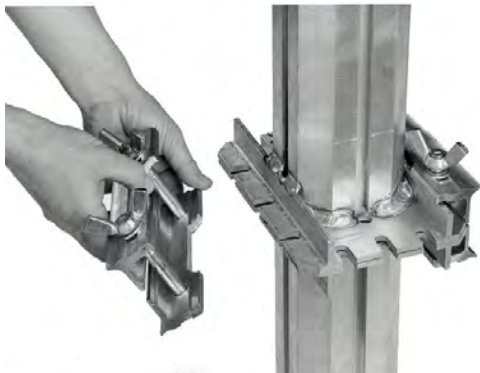

Use two (2) Connection Brackets per connection
Insures full compression strength through the Mega Props

Mega Clamp R12x50



Used to connect the Mega Alum Beam 225 to the Mega Prop (or Mega Jack) end plate

Code No.	Description	Weight	Weight
0102-0790-000010	Mega Splice Plate Set	16.00 Kg	35.20 lbs
0102-0790-000001	Mega Connection Bracket	0.80 Kg	1.76 lbs
0102-0790-000005	Mega Clamp R12x50	0.25 Kg	0.55 lbs

Components

Mega Clamp R12x100

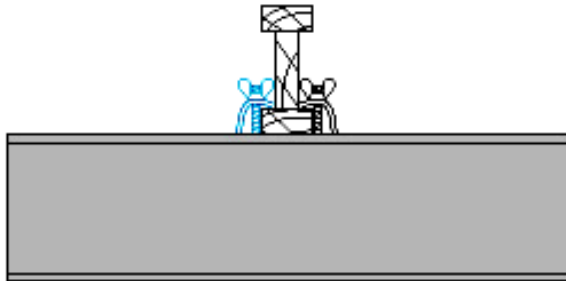

Mega Swivel head Plate
(up to 33°)



Mega Half Coupler



Connected with 4 pcs
 $\frac{1}{2}$ "x 1.5" Bolts and Nuts

Used to connect 1.9" scaffold
tubing to the Mega Props

Mega Retainer Claw

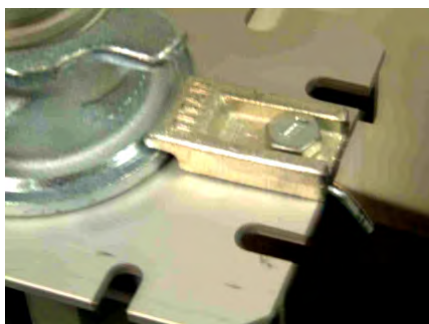

Used at the end plate of MegaProps
or Mega Outer Ext to retain the
Mega Jack. Required when Mega
Jacks are used both top and bottom
and the shoring towers will be crane
handled as tables

Code No.	Description	Weight	Weight
0102-0790-000011	Mega Clamp R12x100	0.30 Kg	0.66 lbs
0102-0790-000003	Mega Swivel Head Plate	2.70 Kg	6.0 lbs
0102-0790-000002	Mega Half Coupler	1.40 Kg	3.0 lbs
0102-0790-000009	Retainer claw	0.30 Kg	0.66 lbs

Components

Mega Barella

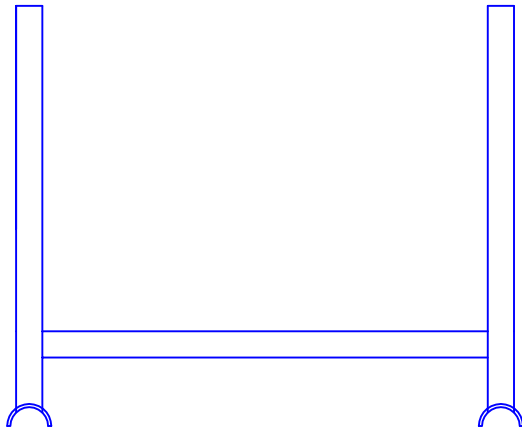

Mega Steering Wheels with
brakes



Mega Rigid Wheels



Mega Spanner

Code No.	Description	Weight	Weight
0102-0790-000022	Mega Barella 4'-8"x2'-10" h=1'-11"	38.00 Kg	83.8 lbs
0102-0790-000023	Mega Rigid wheels	5.50 Kg	12.0 lbs
0102-0790-000024	Mega Steering wheels	6.20 Kg	13.7 lbs
0102-0790-000008	Mega Spanner	2.50 Kg	5.5 lbs

Components

Transportation

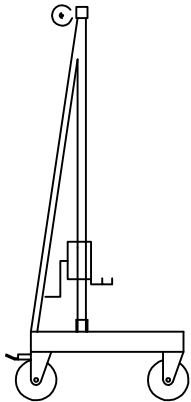

Mega Trolley

All 4 wheels are steering wheels. The trolley capacity is 2,248 lbs (10 kN).

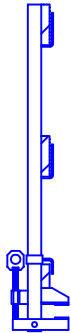

Mega Guard Rail Post

This post works with the H20 Girder, the AluBeam 225, as well as with lumber & plyform decks.

Mega Hinge Plate



Code No.	Description	Weight	Weight
0102-0790-000014	Mega Trolley	124.00 Kg	273.2 lbs
0102-0790-000015	Mega Guard Rail Post	12.00 Kg	26.5 lbs
0102-0790-000013	Mega Hinge Plate	9.30 Kg	20.5 lbs

Height Range

Mega Prop # 2

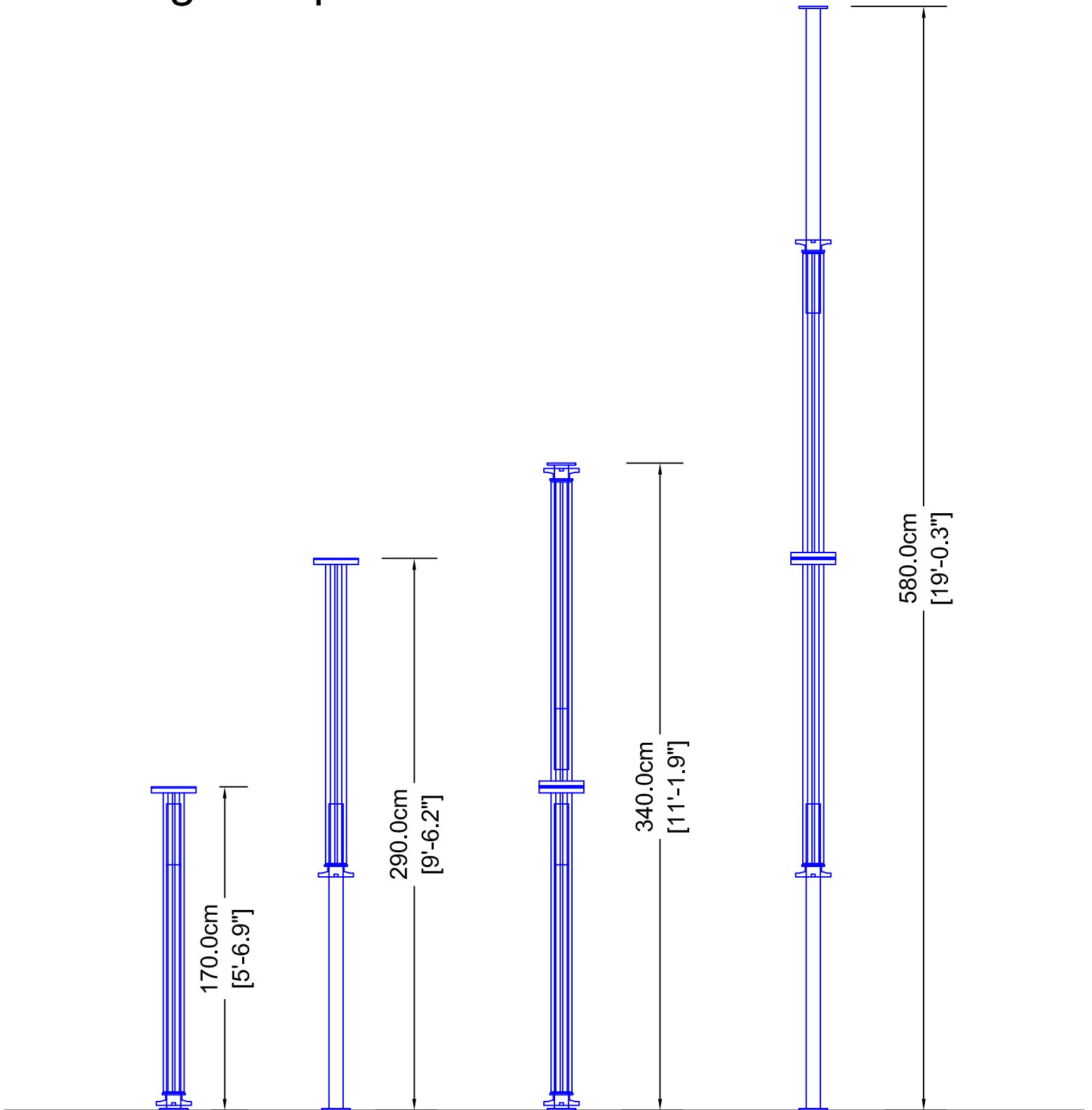

Height Range

Mega Prop # 4

4 + # 2 Mega Prop

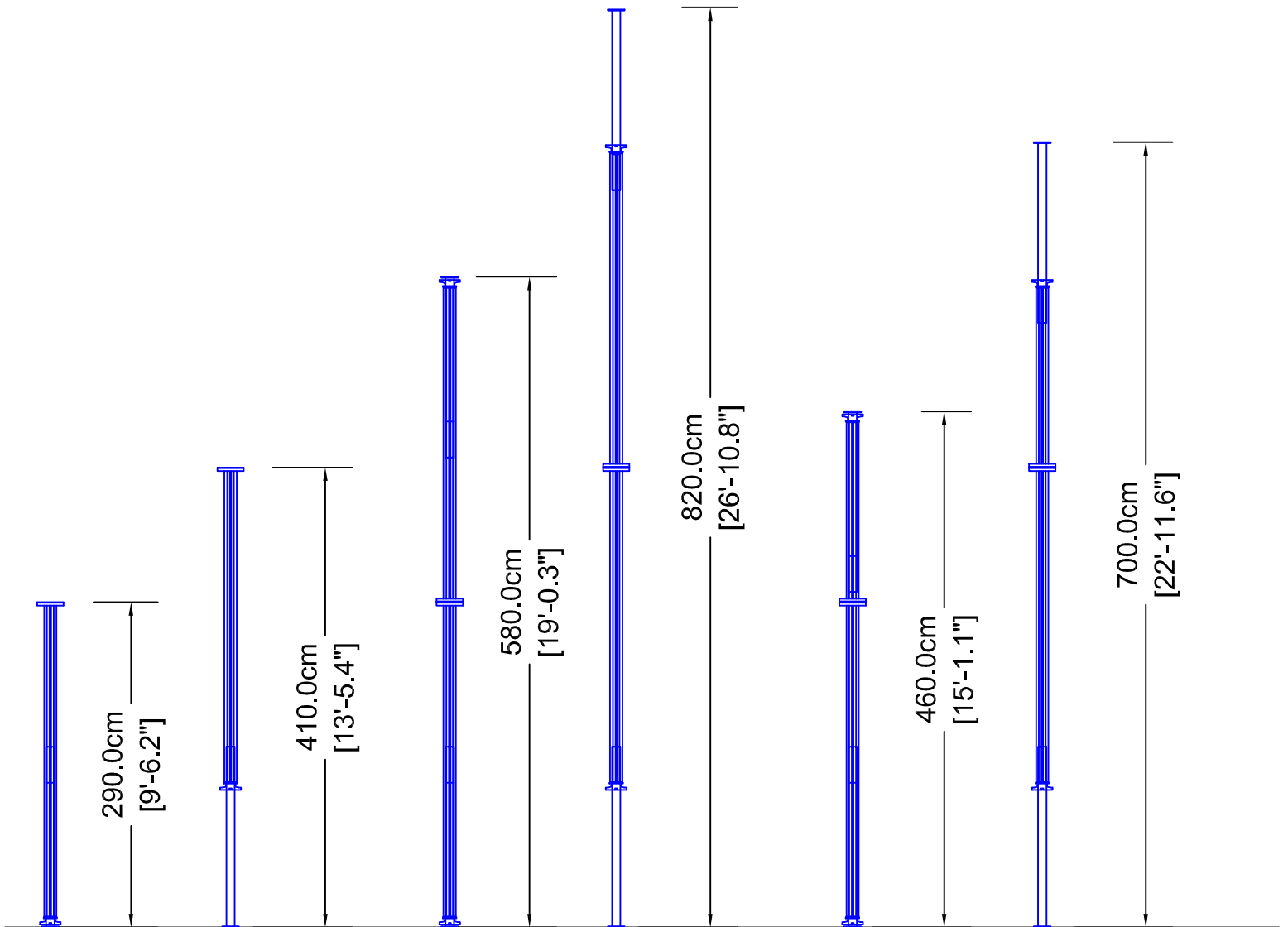

Height Range

Mega Prop # 6

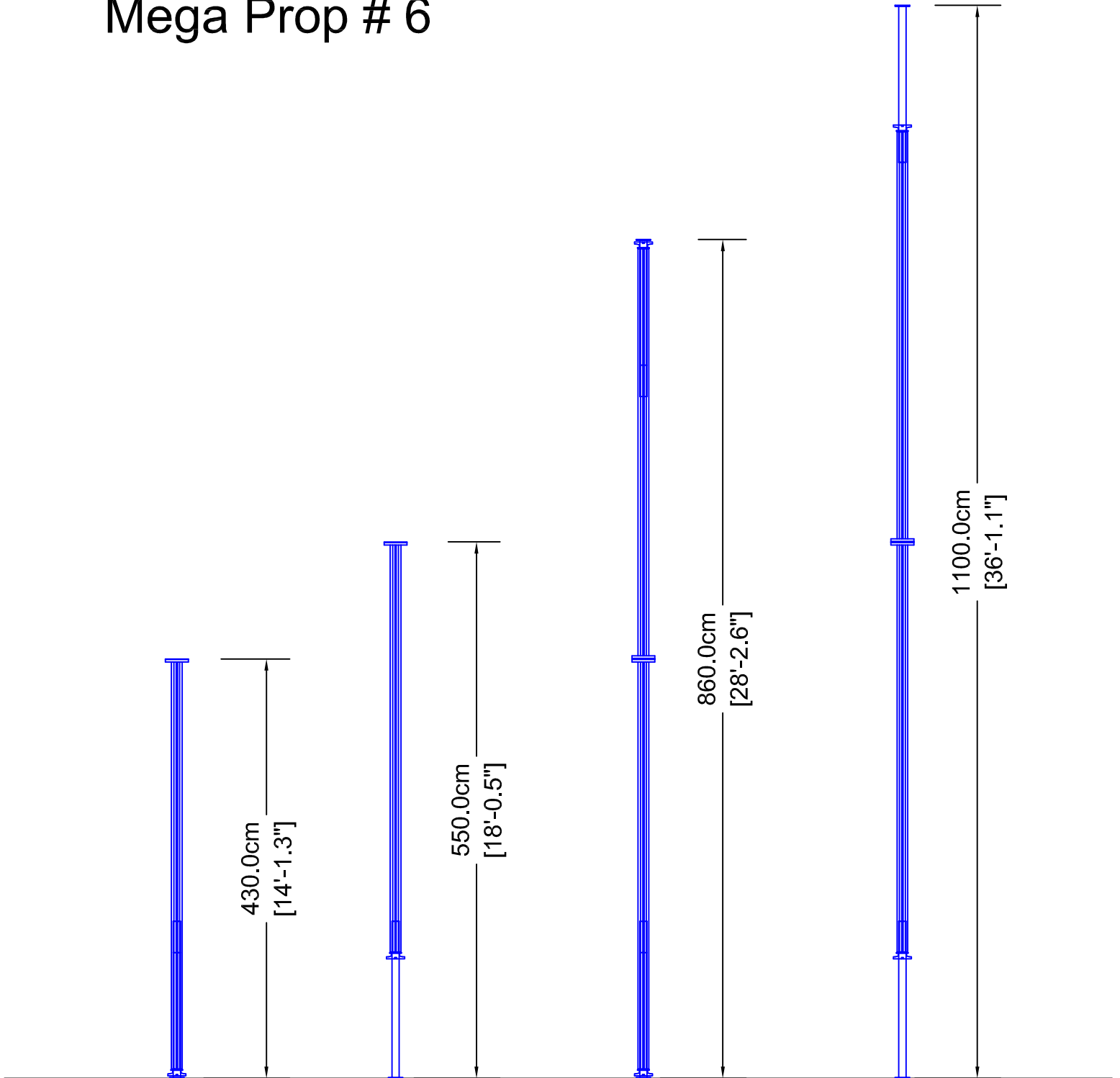

Height Range

6 + # 2 Mega Prop

6 + # 4 Mega Prop

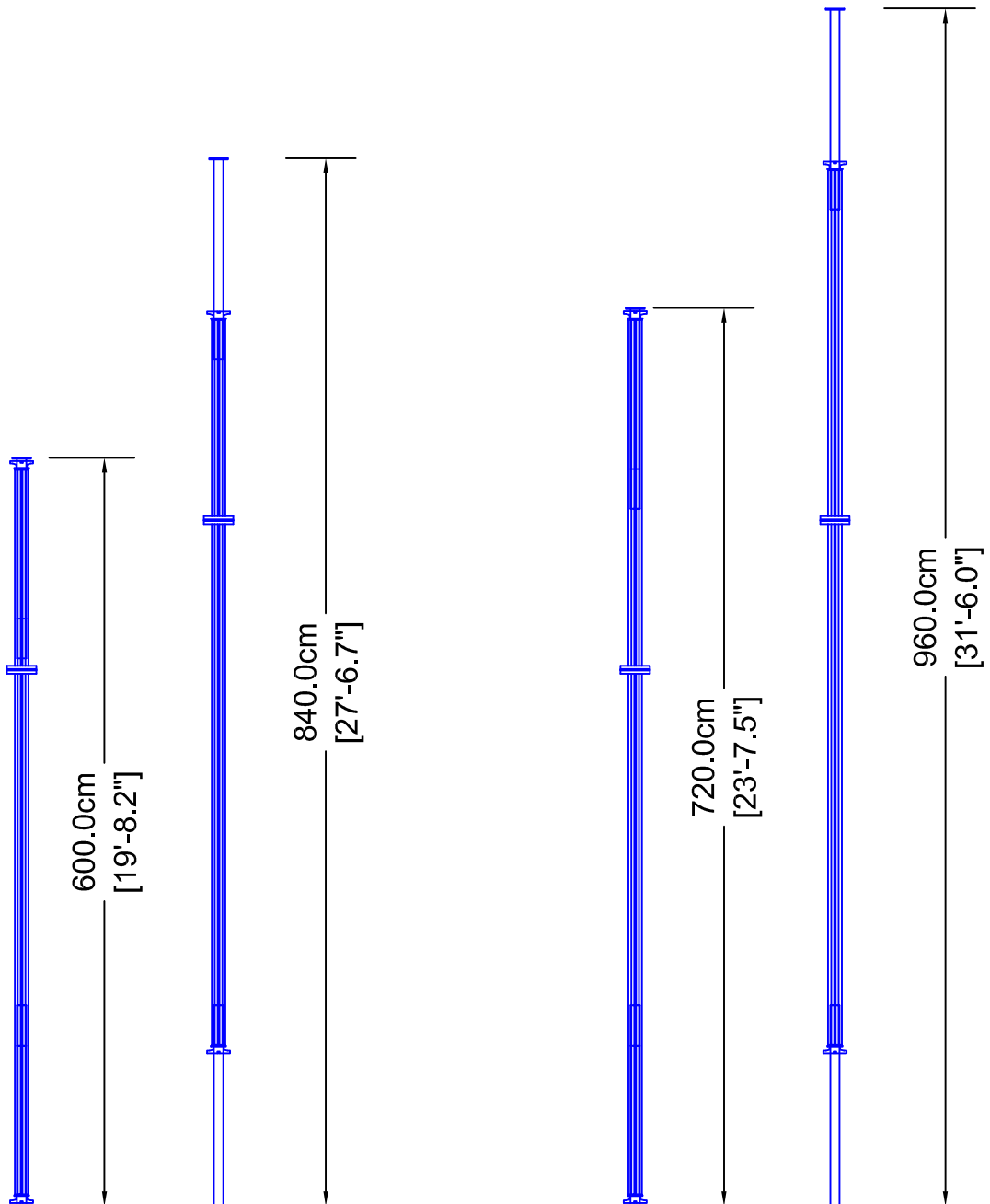

Height Range

Mega Jack 1.2m

Mega Jack 0.4m

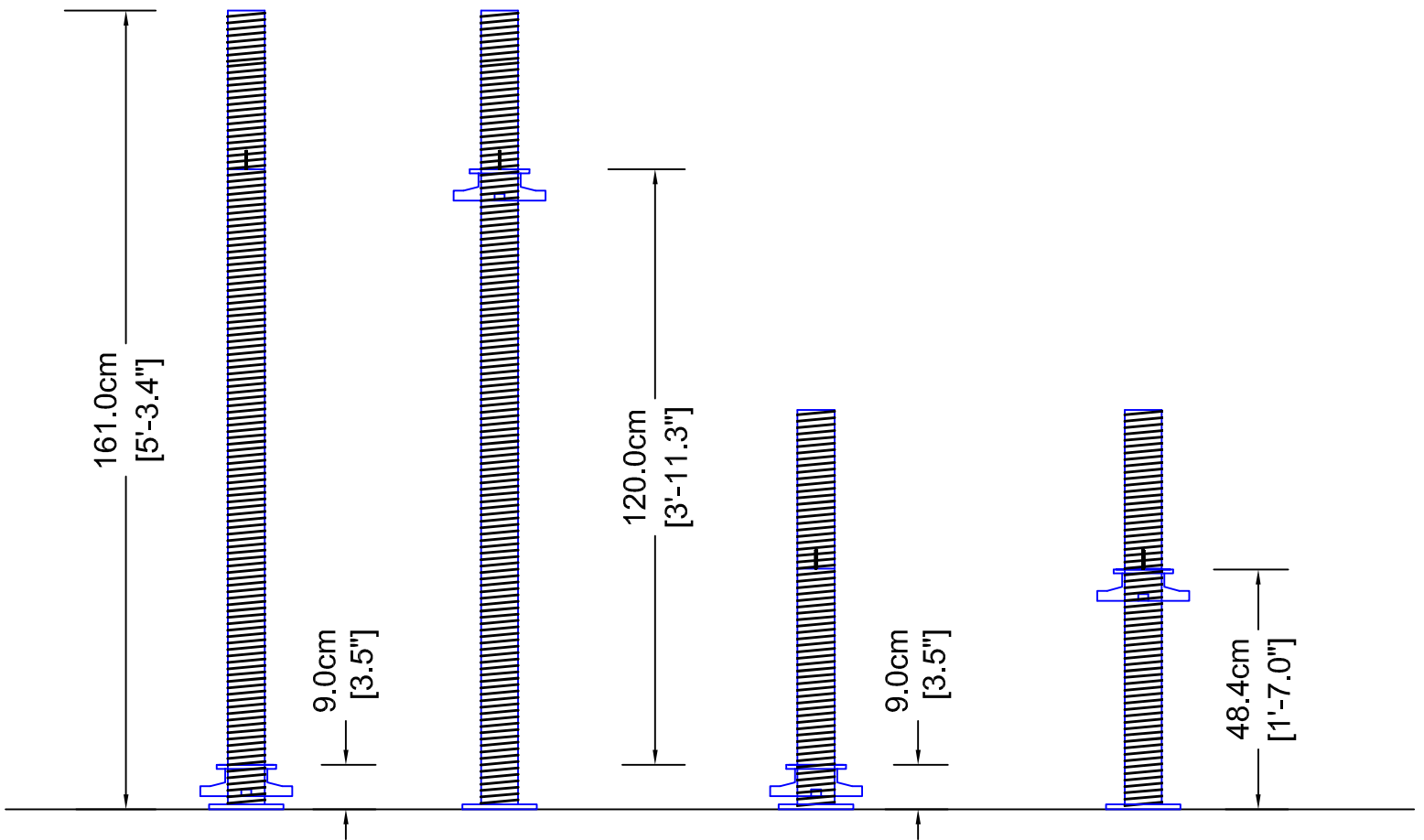

Retainer Clip

Spring-loaded latching device clips over flange on the jack's wing nut to keep the jack from sliding out of the leg when the falsework is crane-handled. The clip allows the wing nut to be rotated to extend or retract the jack as needed.

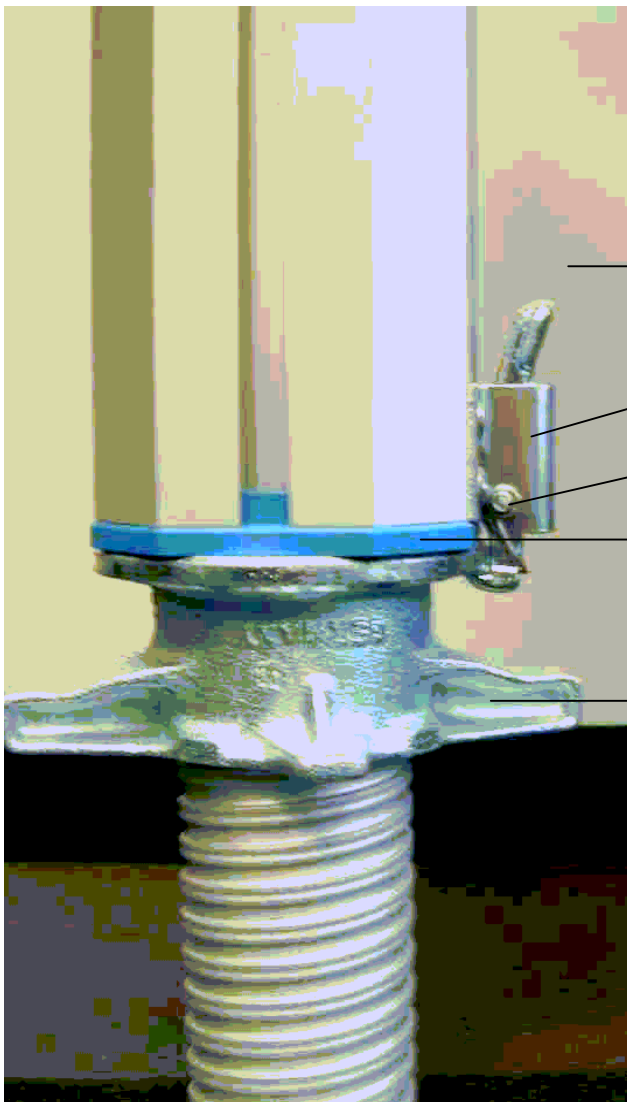

Outer Leg

Latch

Spring

Flange Washer

Wing Nut

Mega Jack

Mega Frame Connection



The Mega Frame is connected to the Mega Prop at 3 points with a spring-loaded wing nut and T-bolt.



Push the wing nut into the slot in the leg and turn 90 degrees. This will turn the T-bolt in the slot and allow the wing nut to be tightened.

Note:

The groove stamped into the end of the T-bolt which indicates the alignment of the T-head.

Beam Connection

Connect the Mega Alum Beam 225 to the Mega Prop or Mega Jack end plate with the Mega Clamp R12x50.



Connect the H20 Girder to the AluBeam Stringer using the H20 Clamp R12x100.



MegaShore Load Charts

MegaShore Frame Loads

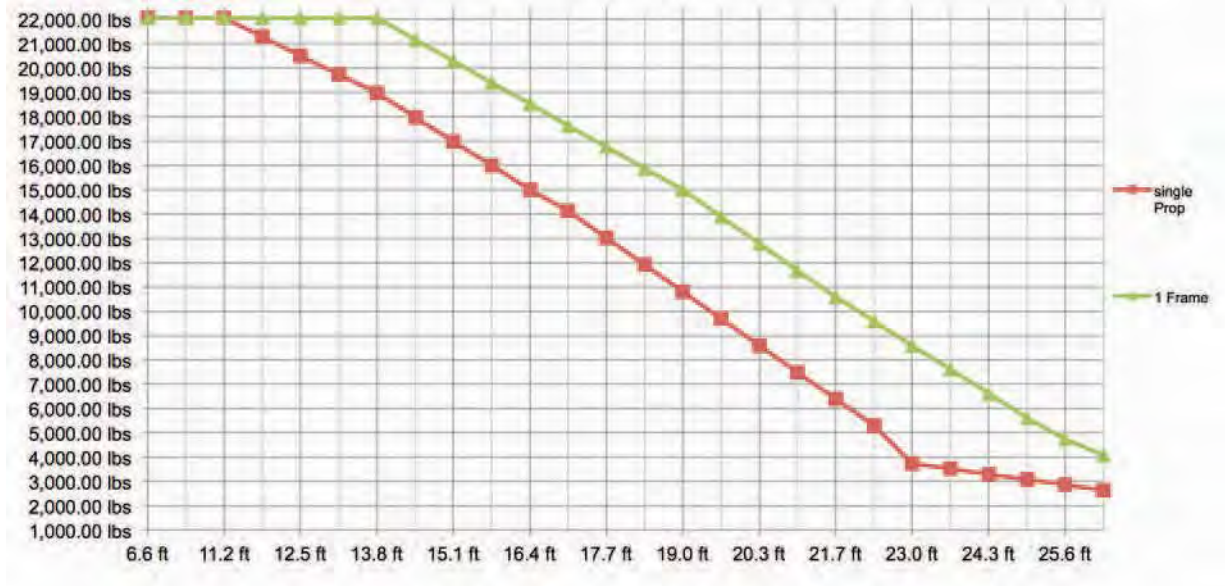

MegaShore Frame Loads

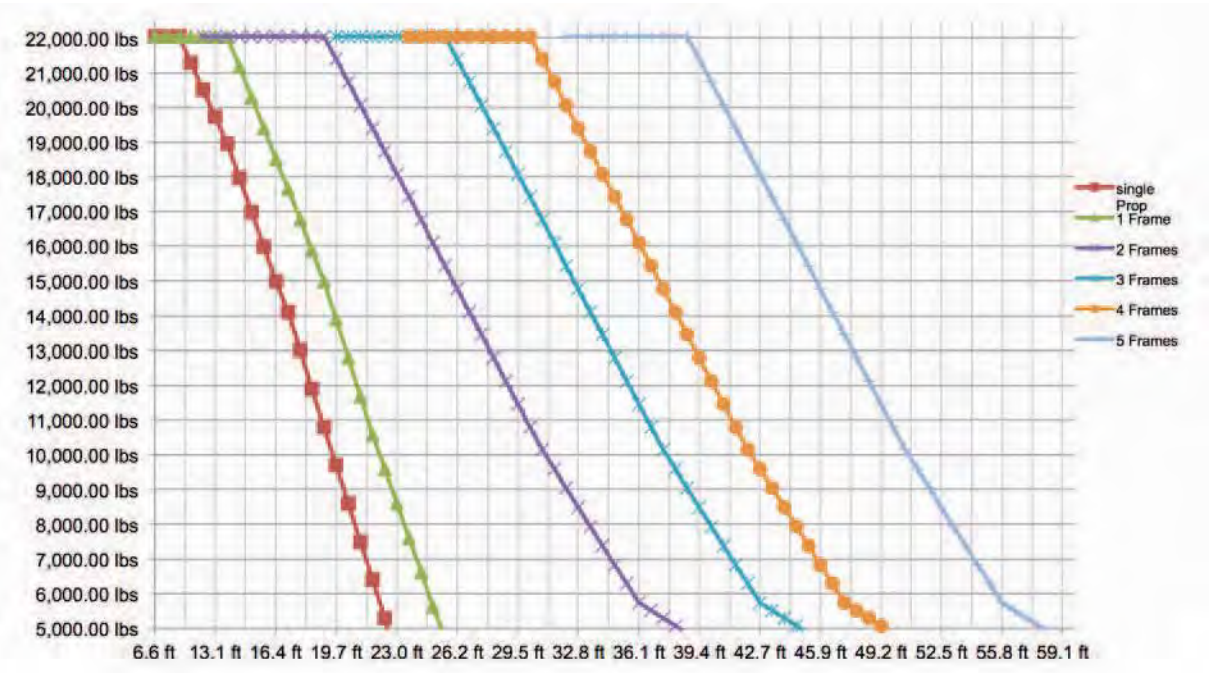

MegaShore Load Charts

MegaShore Frame Loads

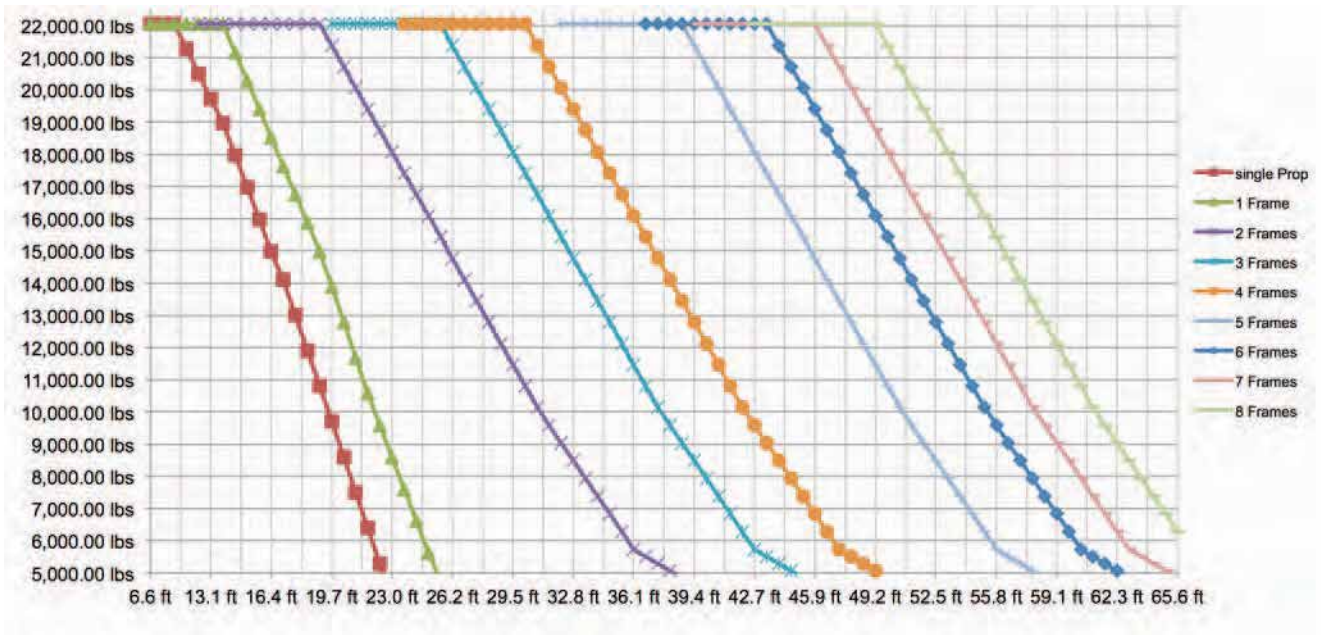

Megashore Screw Jack Extension

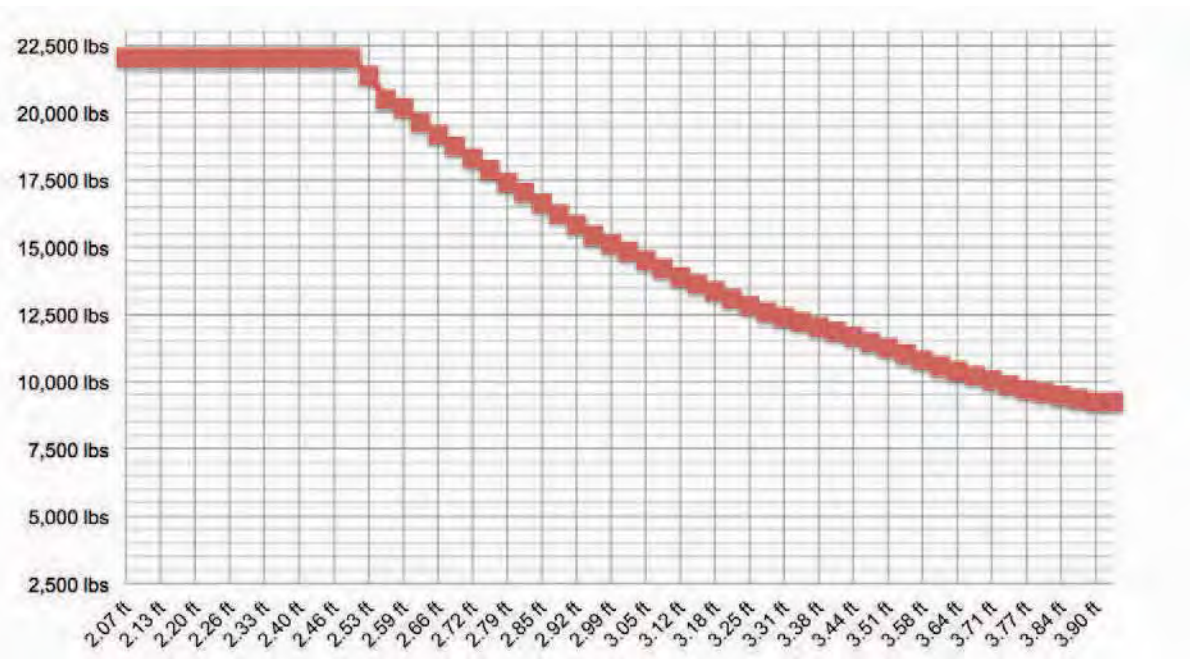

Timber Beam Load Charts

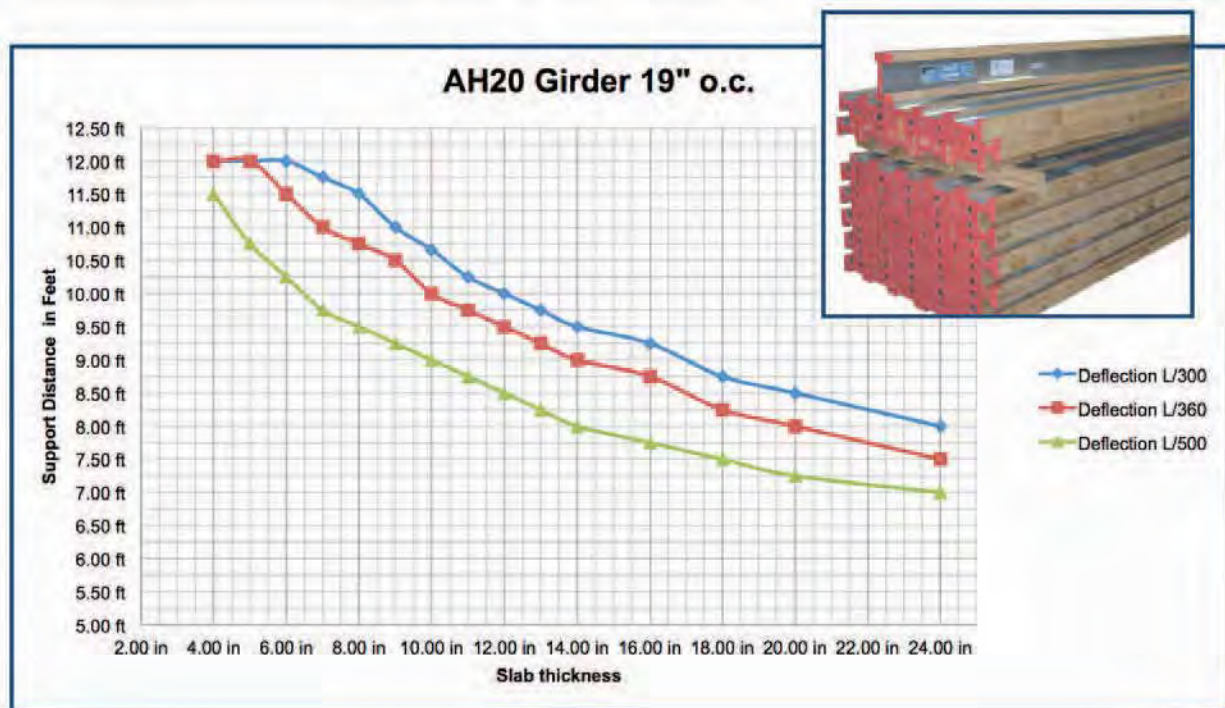

Mega Frame Connection

The Mega Frames should be located 15" from the end of the Mega Prop

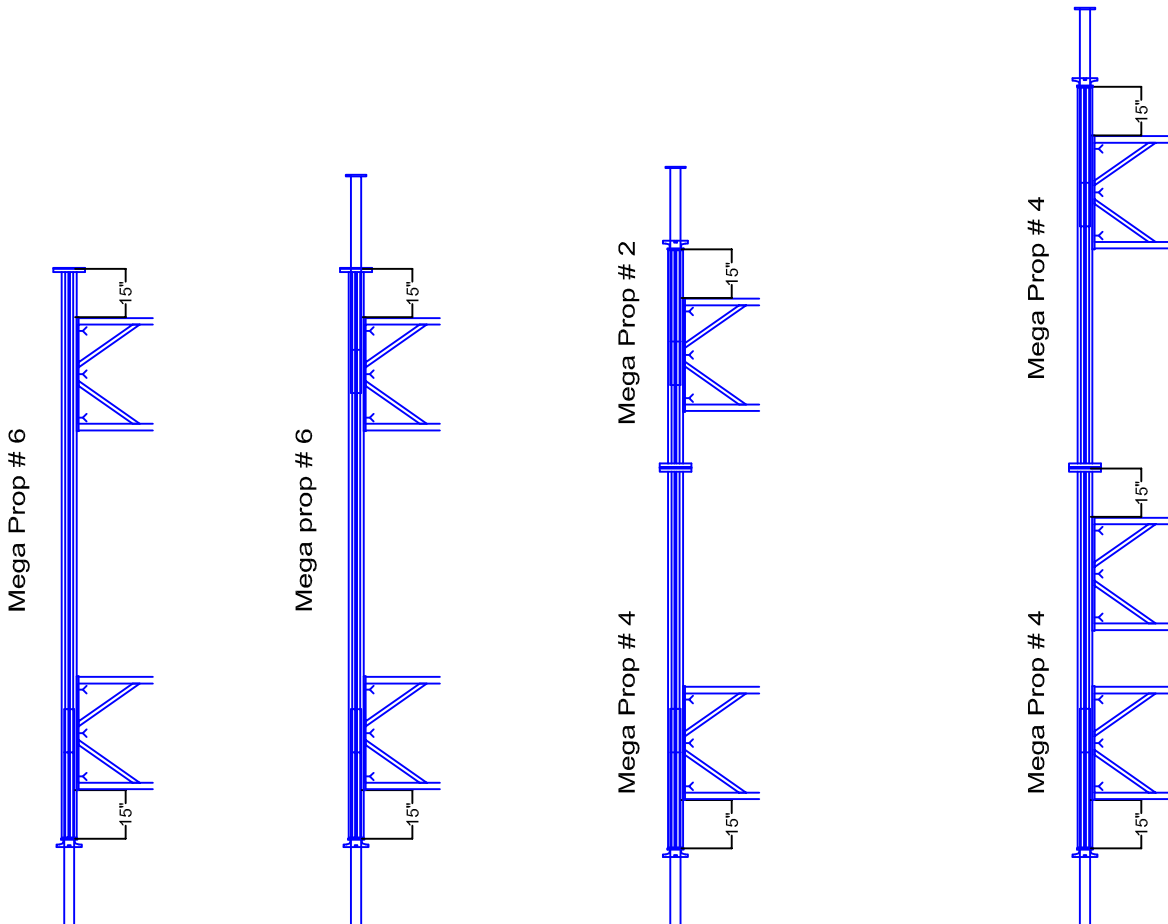
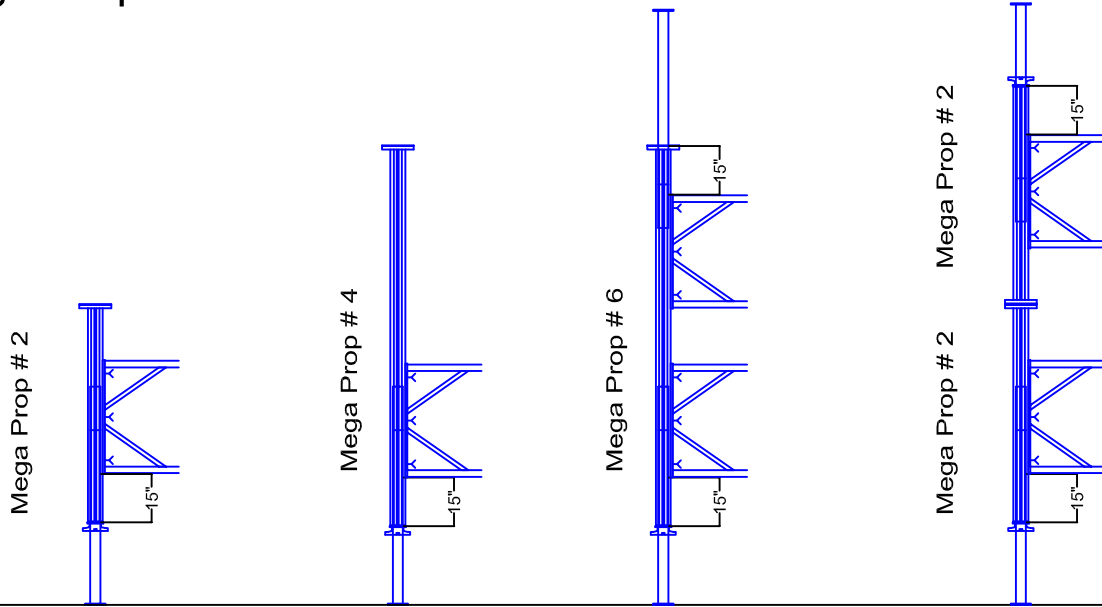

Mega Frame Connection

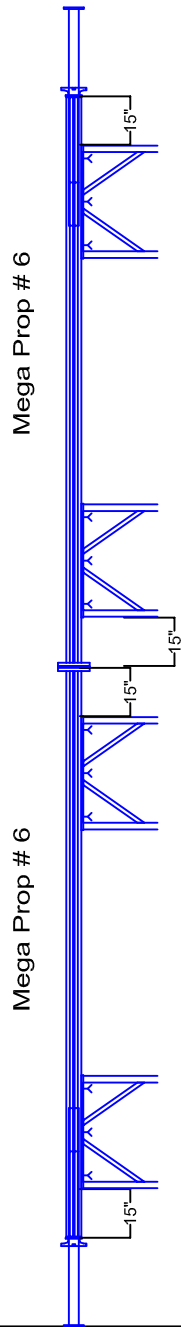
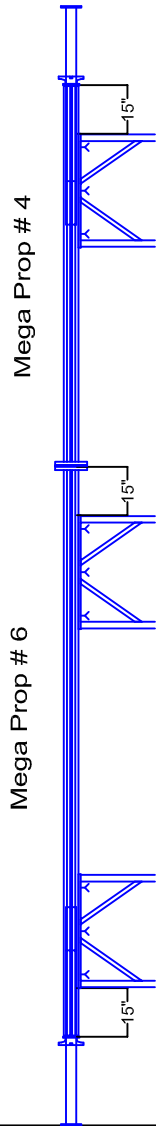
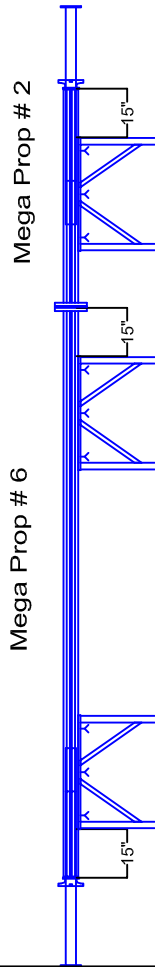

Ledger Frame Connection

Mega Prop # 2

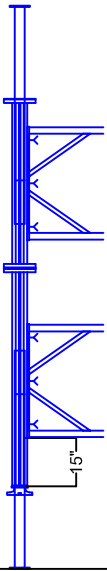

Mega Prop # 2

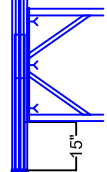

Mega Prop # 2

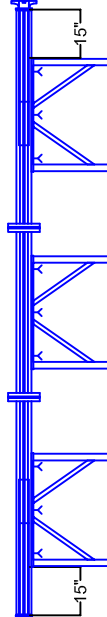

Mega Outer Ext 100-125

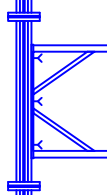

Mega Outer Ext 100-125

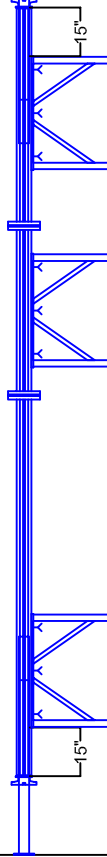

Mega Prop # 4

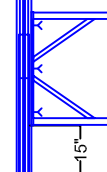

Mega Outer Ext 100-125

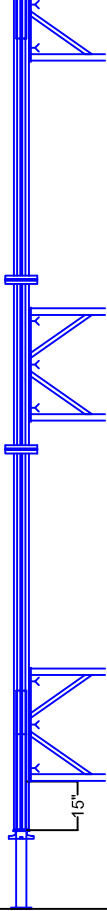

Mega Prop # 4

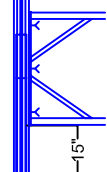

Mega Prop # 6

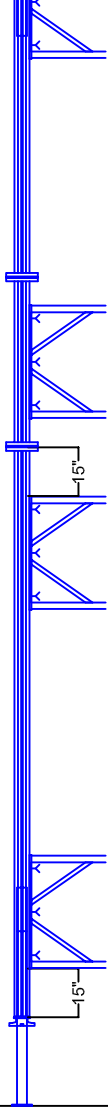

Mega Outer Ext 100-125

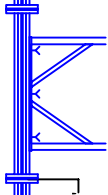

Mega Prop # 6

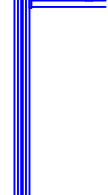

Ledger Frame Connection

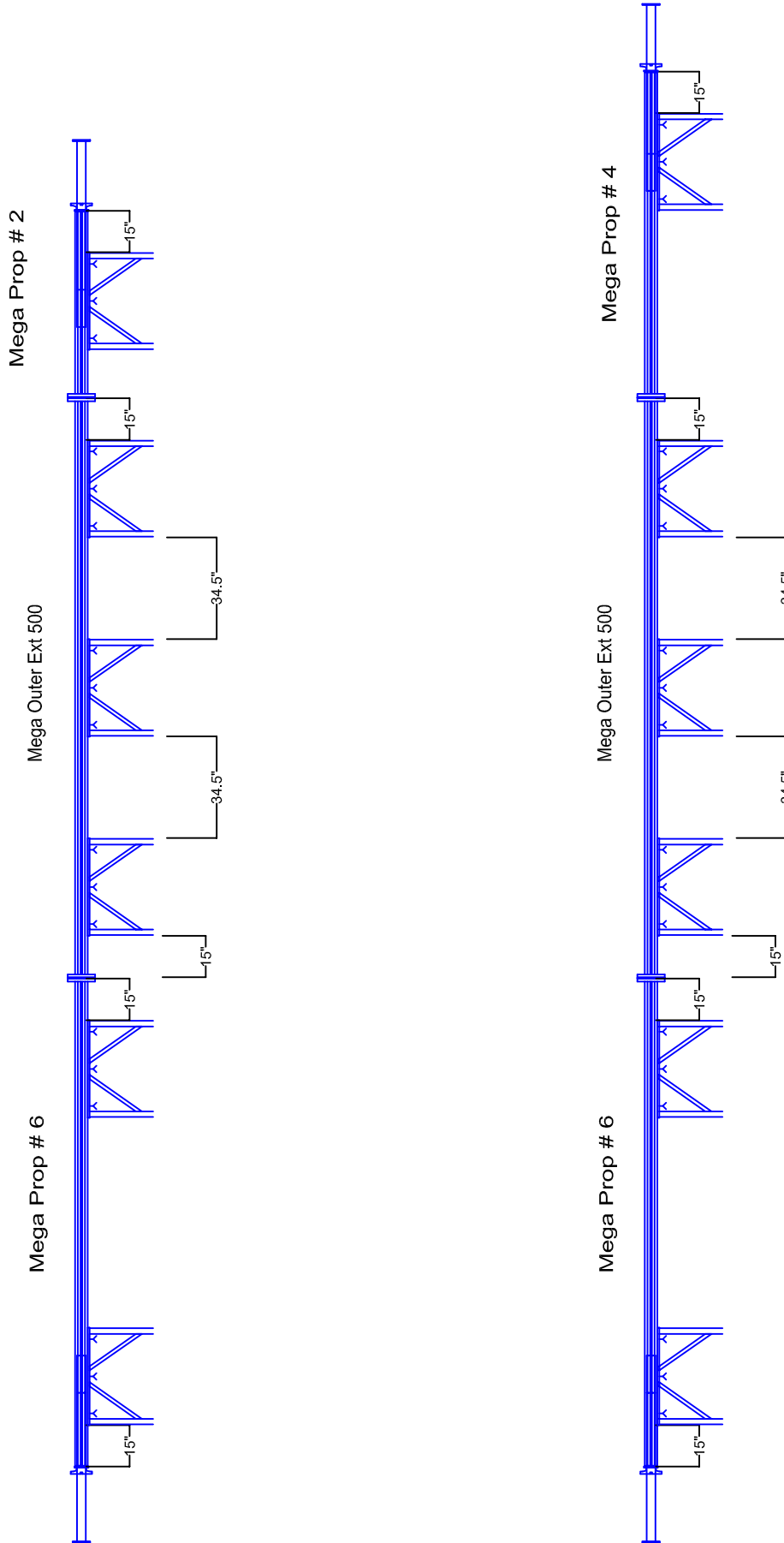

Method of erection

Step 1:

- Place a Mega Prop on the ground.
- Measure the Mega Jack extension.
- Mark the Prop 15" from the Iflon washer (to locate ledger frame).
- Attach the frame to the top slot on the Mega Prop.
- Fasten the middle Mega Frame wing nut (see page 20) snug, but not tight. Check the Mega Frame location against the mark on the leg.
- Fasten the other two Mega Frame wing nuts, then tighten all three.

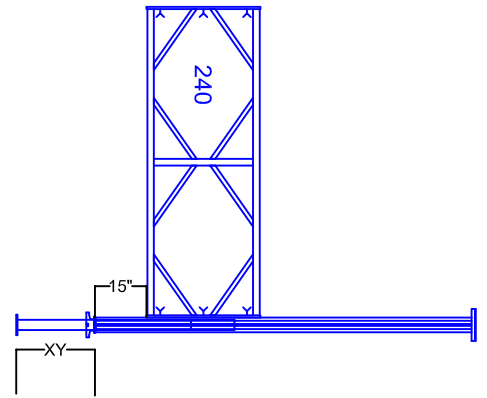

Step 2:

- Rotate the Prop and attached Mega Frame to lay flat on the ground.
- Take the second Mega Prop and measure the Mega Jack extension.
- Mark the Prop 15" from the Iflon washer.
- Attach the Frame to the second Prop as in Step 1.

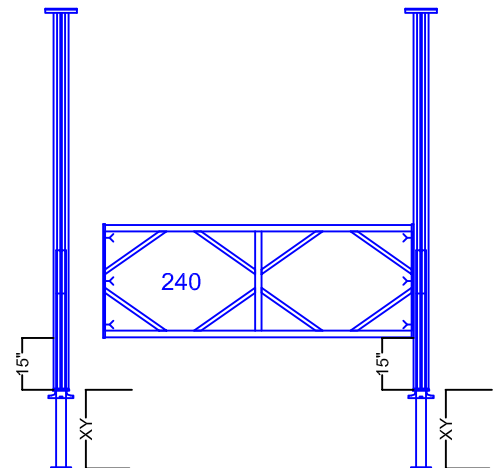

Method of erection

Step 3:

-- Attach two Mega Frames (one to each Prop) so that the Mega Frames are vertical.

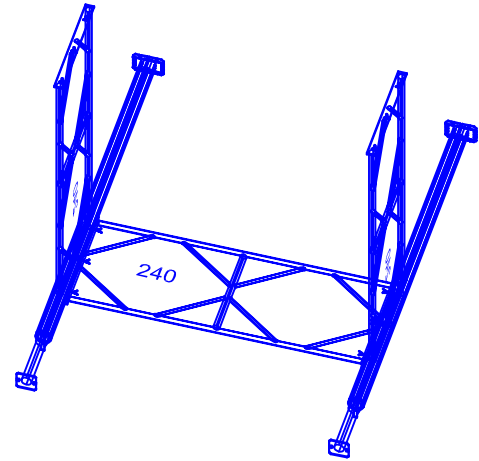

Step 4:

- Repeat Steps 1 & 2 to make a second pair of Props with the Mega Frame attached.

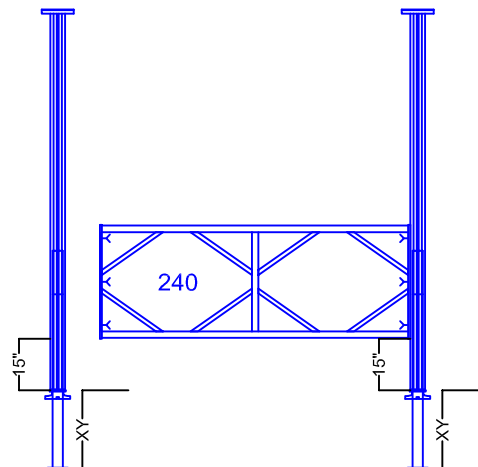

Method of erection

Step 5:

- Tilt up the U-shaped Props with 3 Mega Frames.
- Tilt up the other pair of Mega Props with one Mega Frame and bring them to the U-shaped tower.
- Connect the Mega Frames to the Mega Props making sure to check the 15" dimension from the I-flon washers.

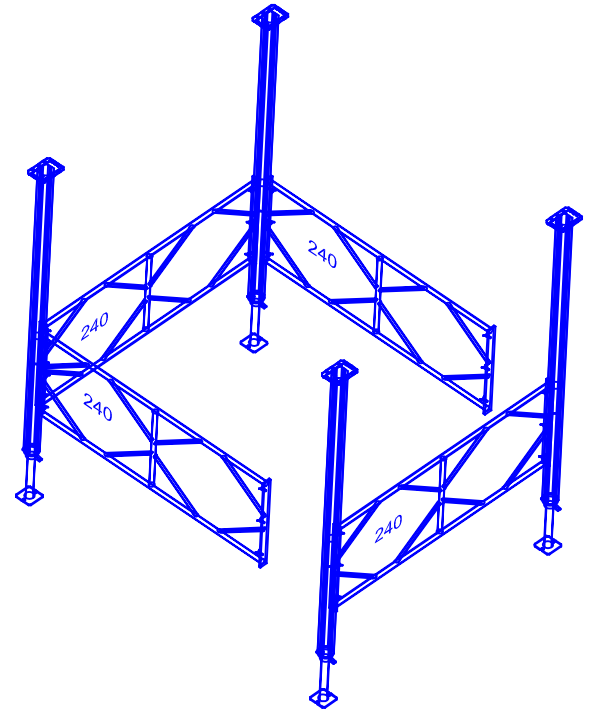

Step 6:

- Check the plumbness of the Mega Props by adjusting the Mega Jacks as required.

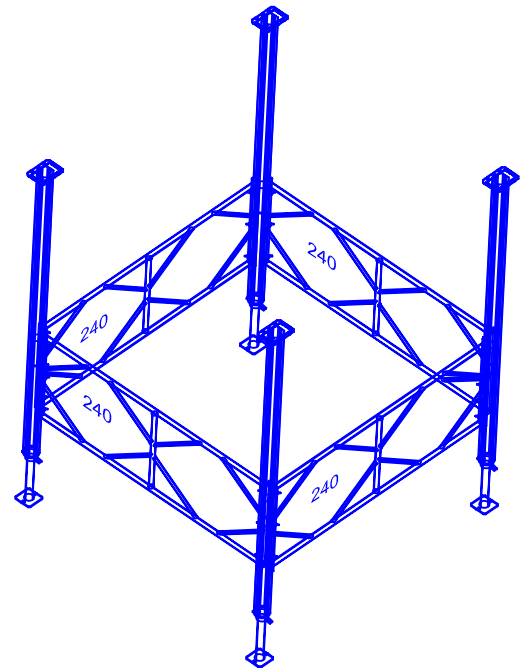

Method of erection

Step 7:

- Connect the Mega Alum Beam 225 to the Mega Prop end plate with the Mega Clamps R12x50.

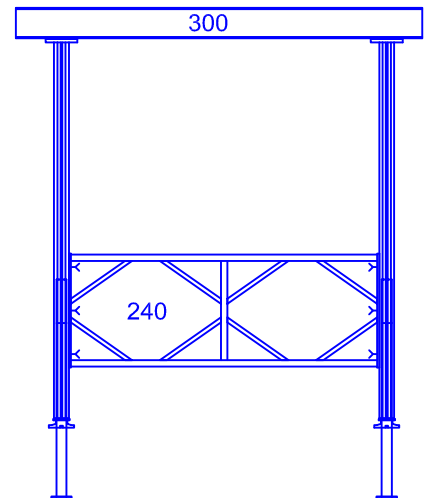

Step 8:

- Connect the AH20 Girders to the Mega Alum Beam 225 with the Mega Clamps R12x100.

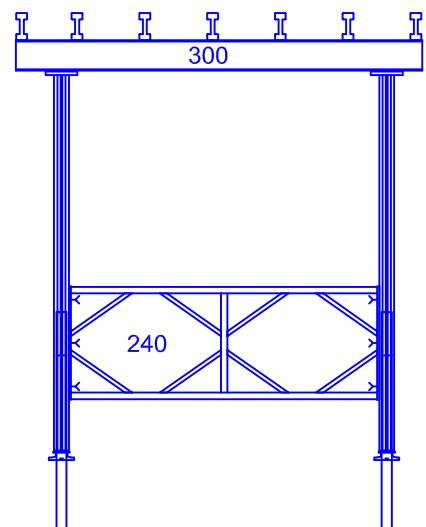

Method of erection

Step 9:

- To move the tower use a minimum of 2 Mega Trolleys.
- Bring the Mega Trolley under the Mega Frame. Align the U-shaped catch on the Trolley with the Mega Frame and crank the handle on the trolley to lift the tower.

The trolleys can also be used to raise (or lower) a tower to facilitate tower height adjustment.

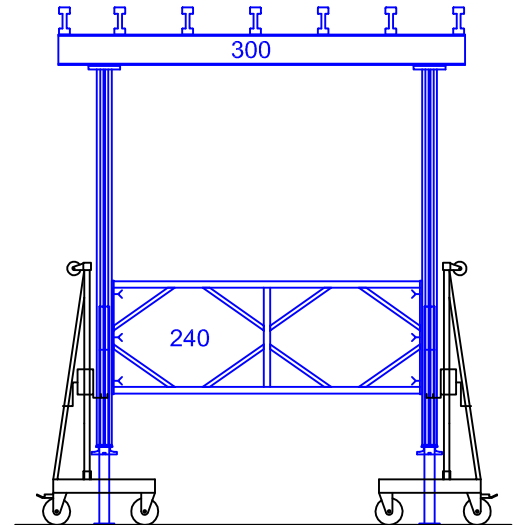

Step 10:

- When the tower height requires more than one Prop to get the required height, be sure to connect the Props together with the Mega Connection Bracket (see Page 10) BEFORE attaching any frames.

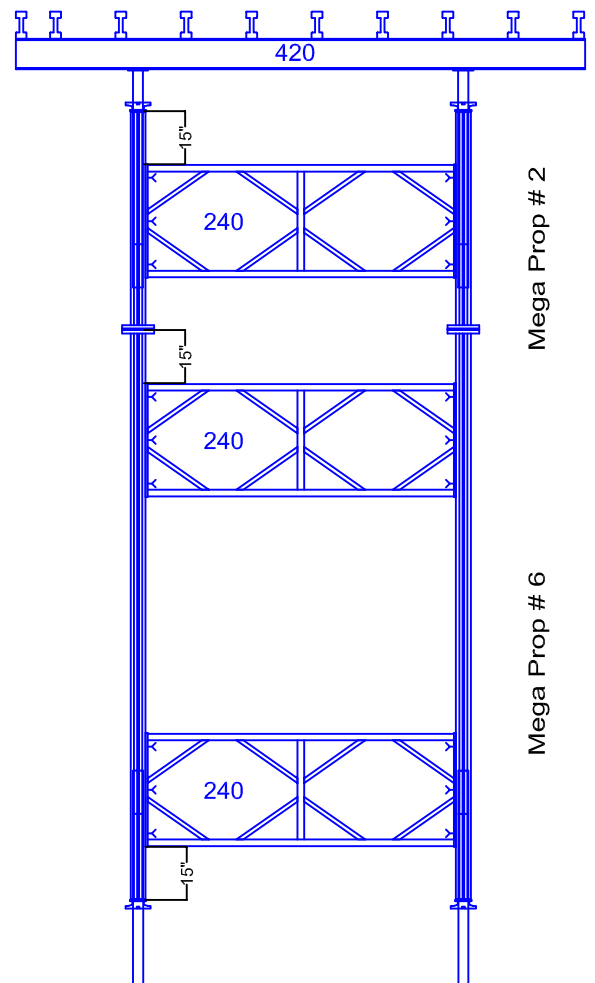

Method of erection

Step 11:

- Put two Mega Prop end plates together. Position the Mega Connection Bracket (see Page 10) as shown in the photo and tighten the wing nuts evenly top and bottom.

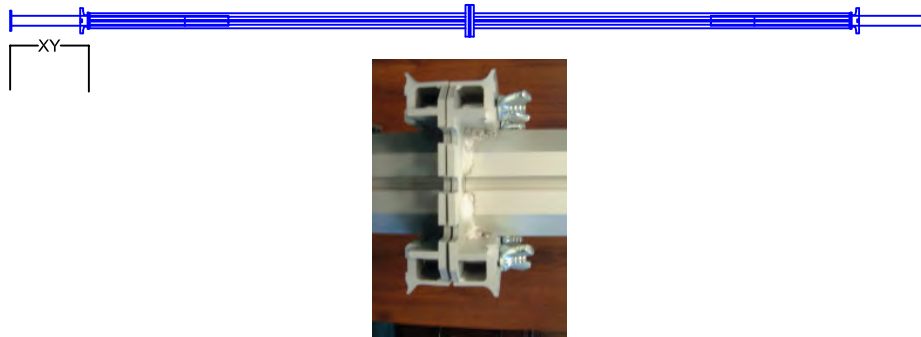

Step 12:

- When a Mega Prop requires a Mega Jack at the top, use the Mega Retainer Claw shown on Page 11.
- Insert the additional Mega Jack into the leg until the Mega Jack's wing nut contacts the end plate.
- Attach the Mega Retainer Claw utilizing one of the middle slots on the Prop's end plate and tighten the claw's wing nut.

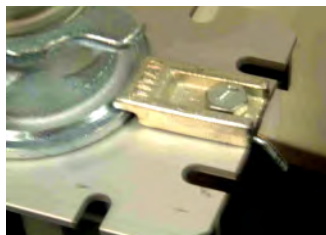

Examples

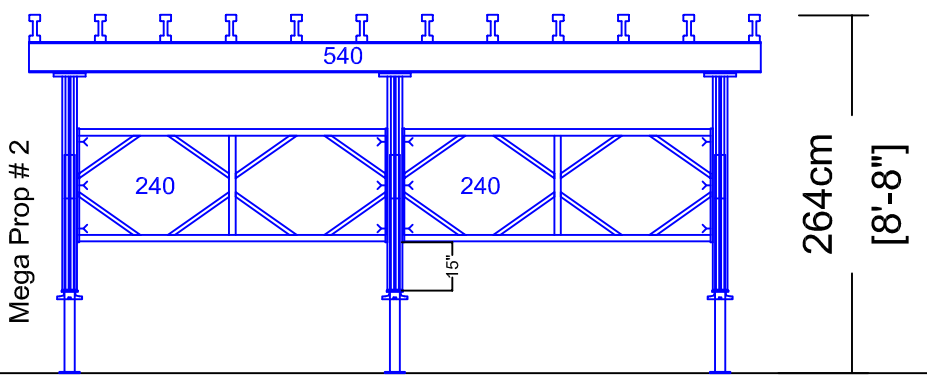
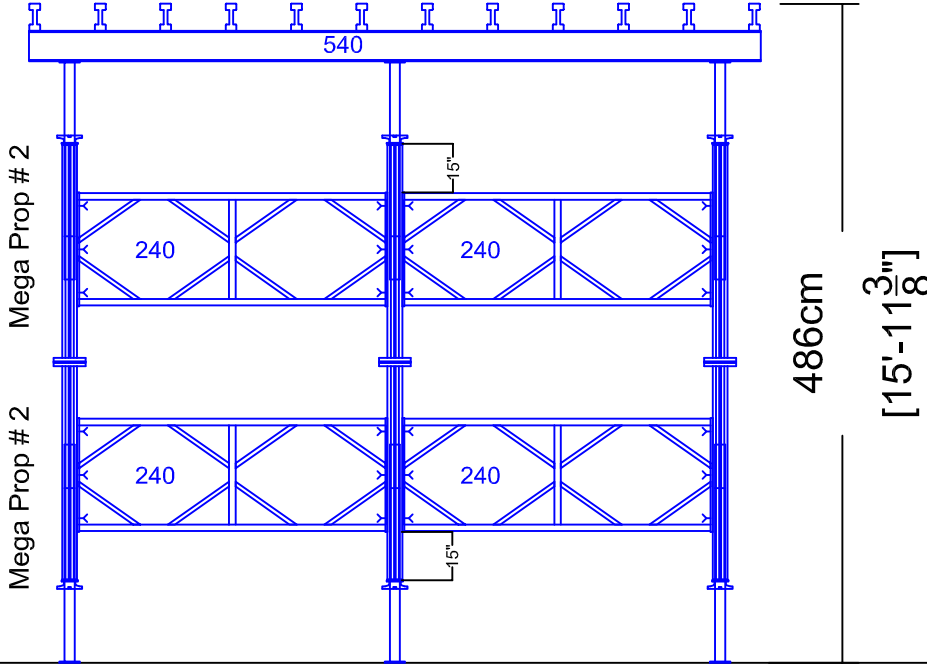

Examples

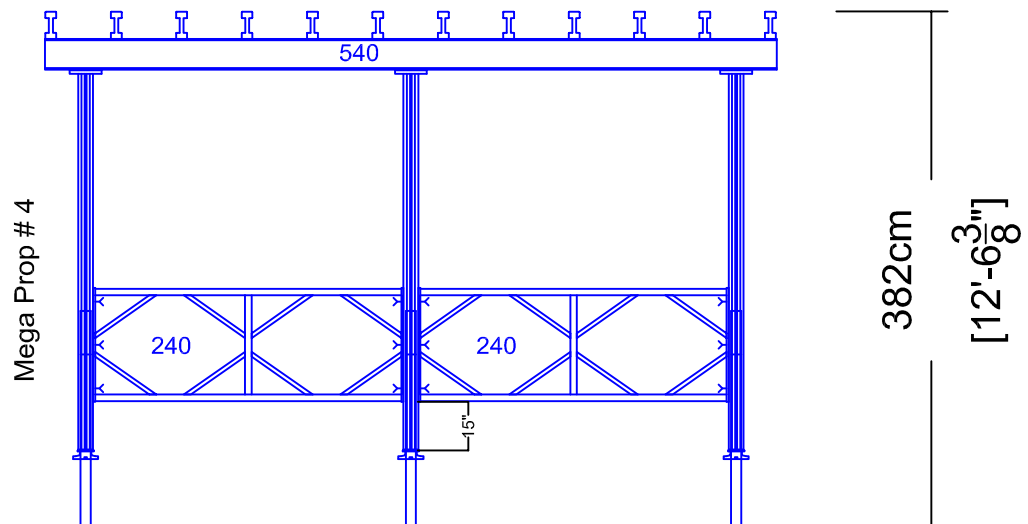
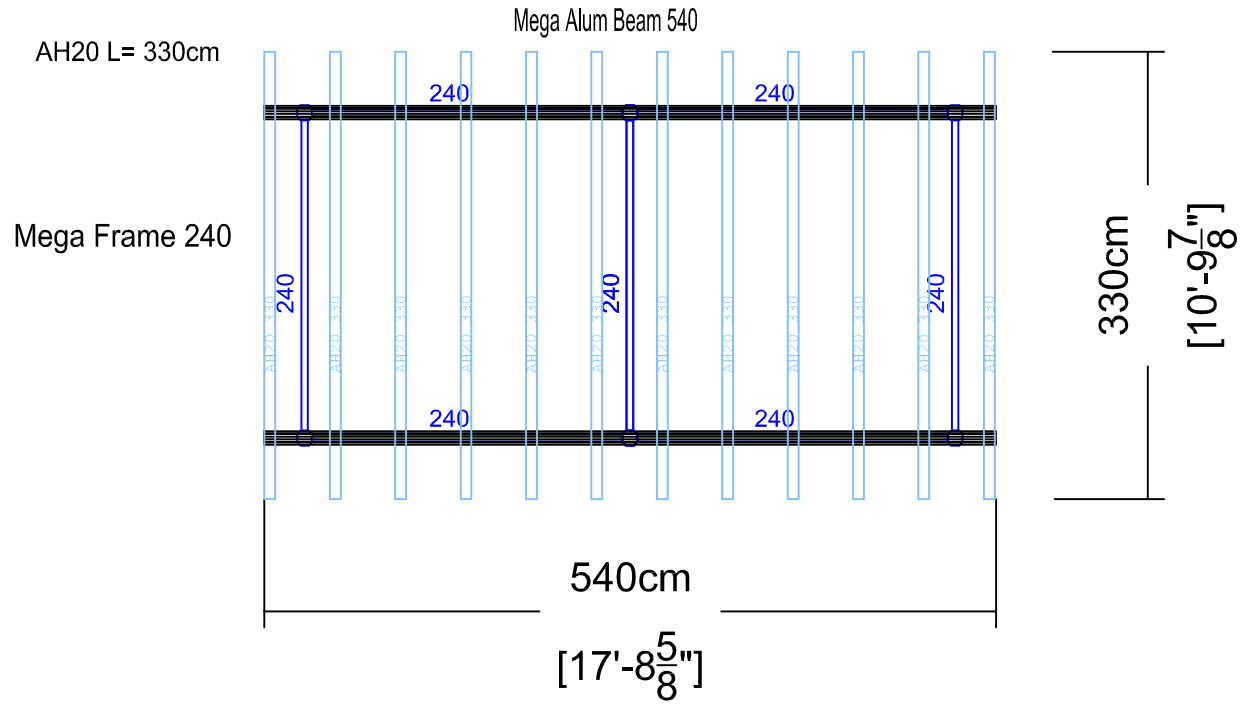

Examples

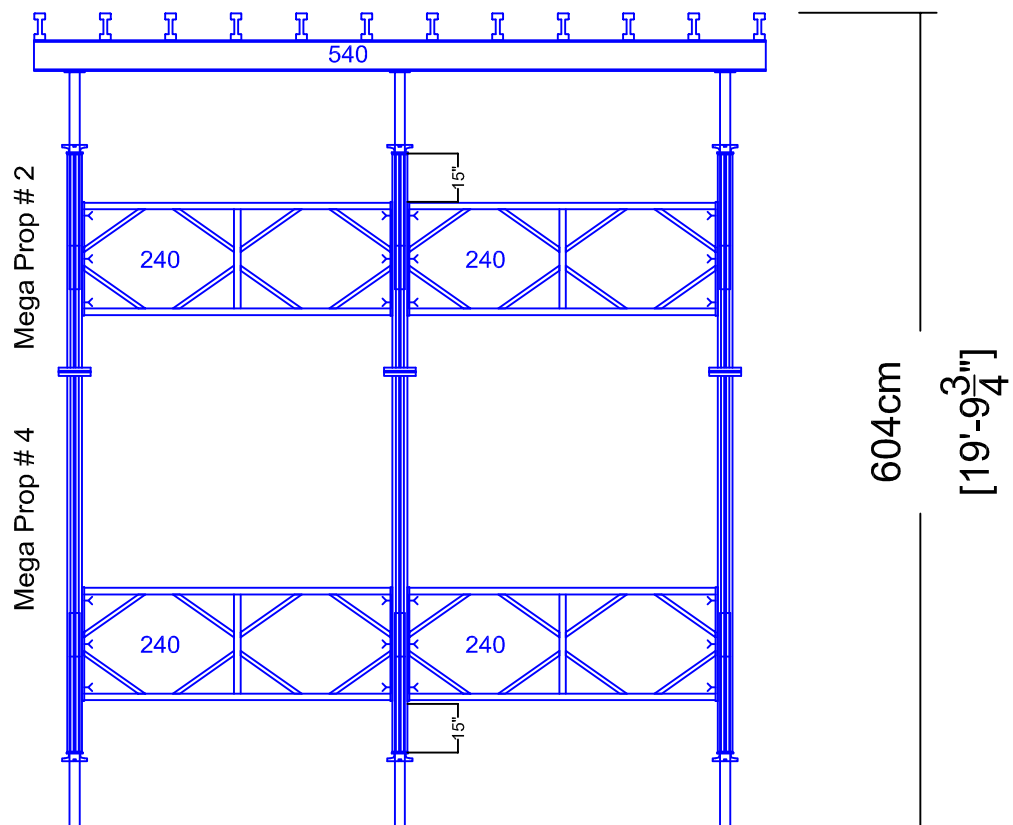
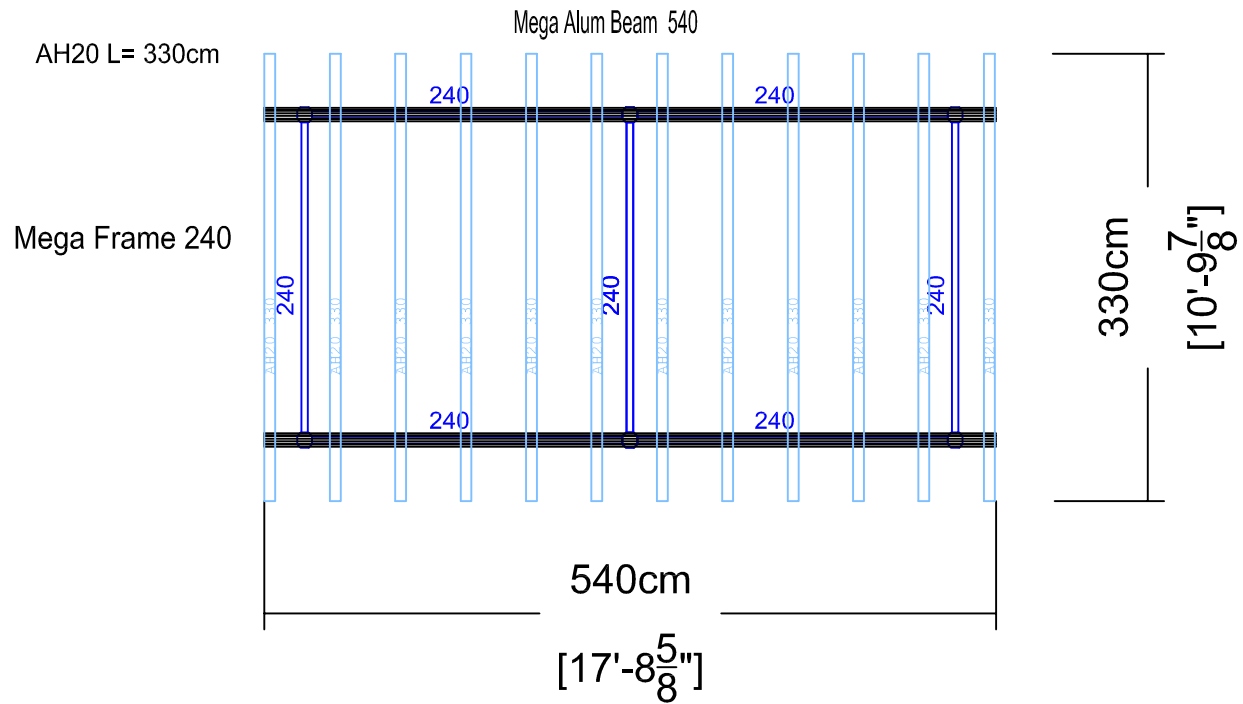

Examples

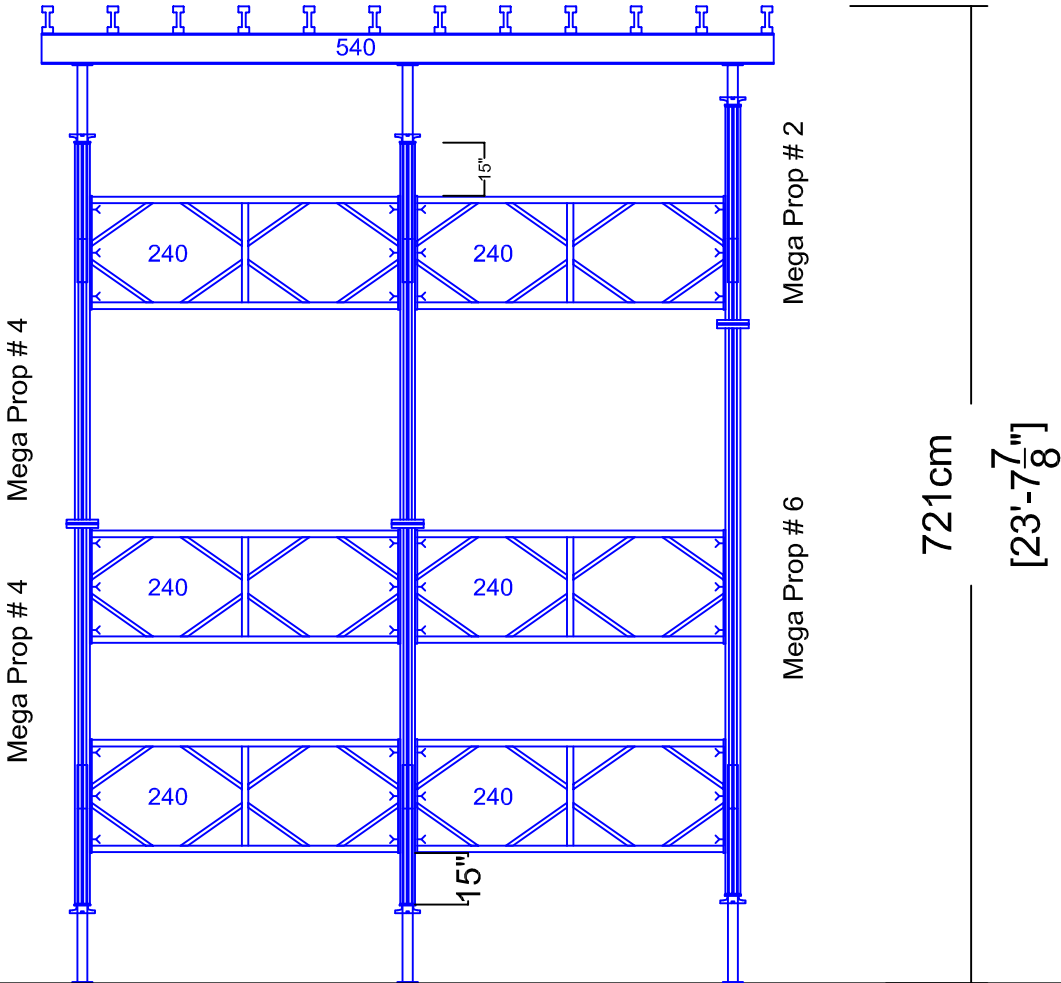

Examples

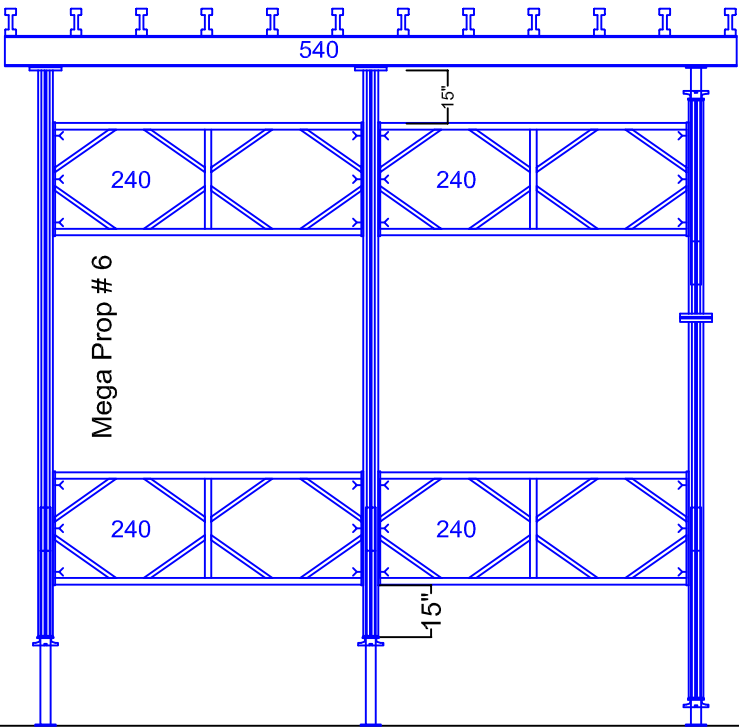

Mega Prop # 4 Mega Prop # 2

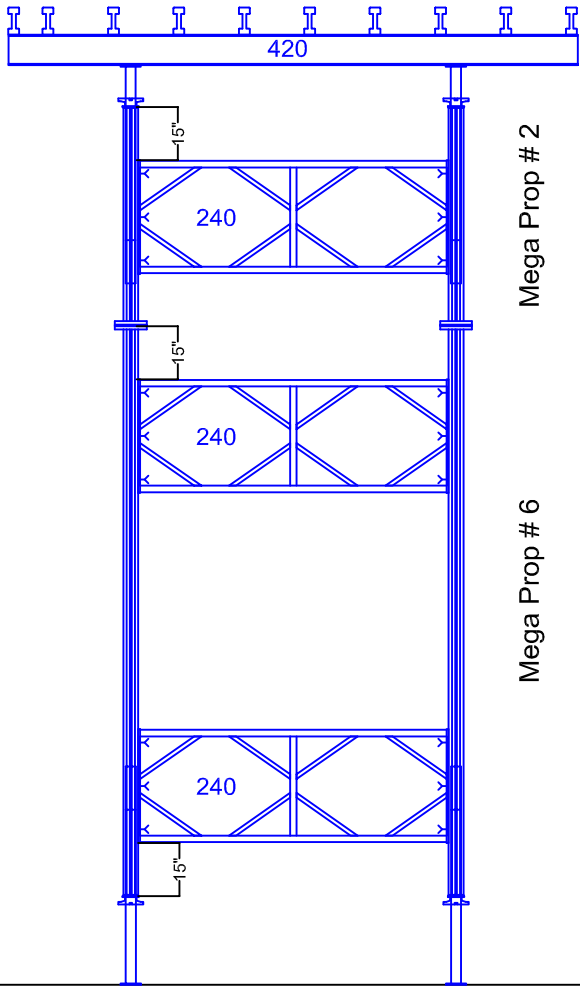

Mega Prop # 6 Mega Prop # 2

Examples

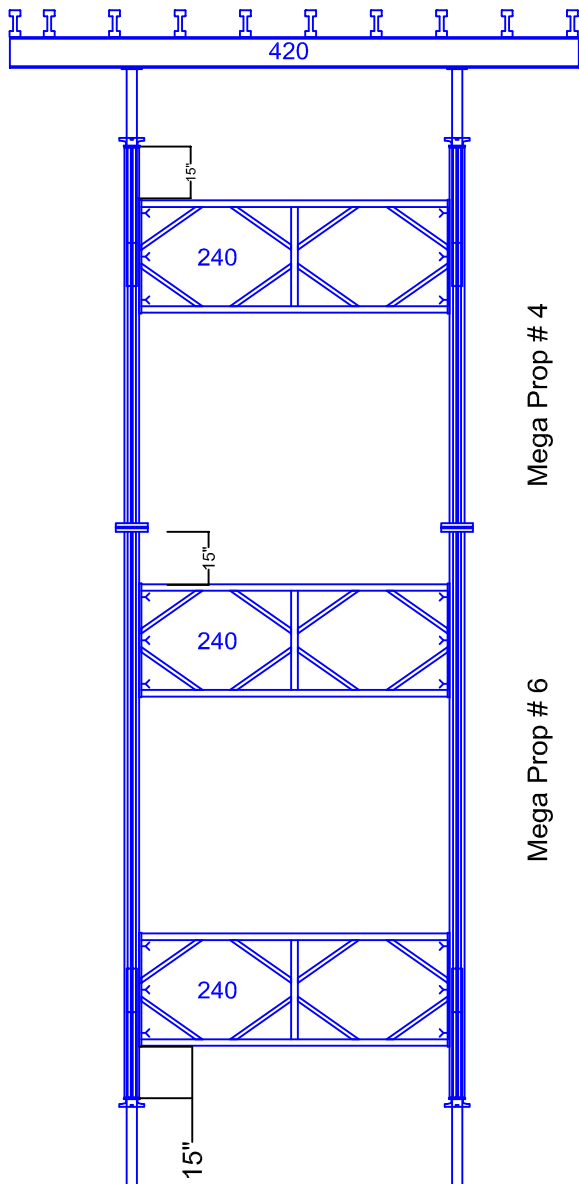

Mega Prop # 4

Mega Prop # 6

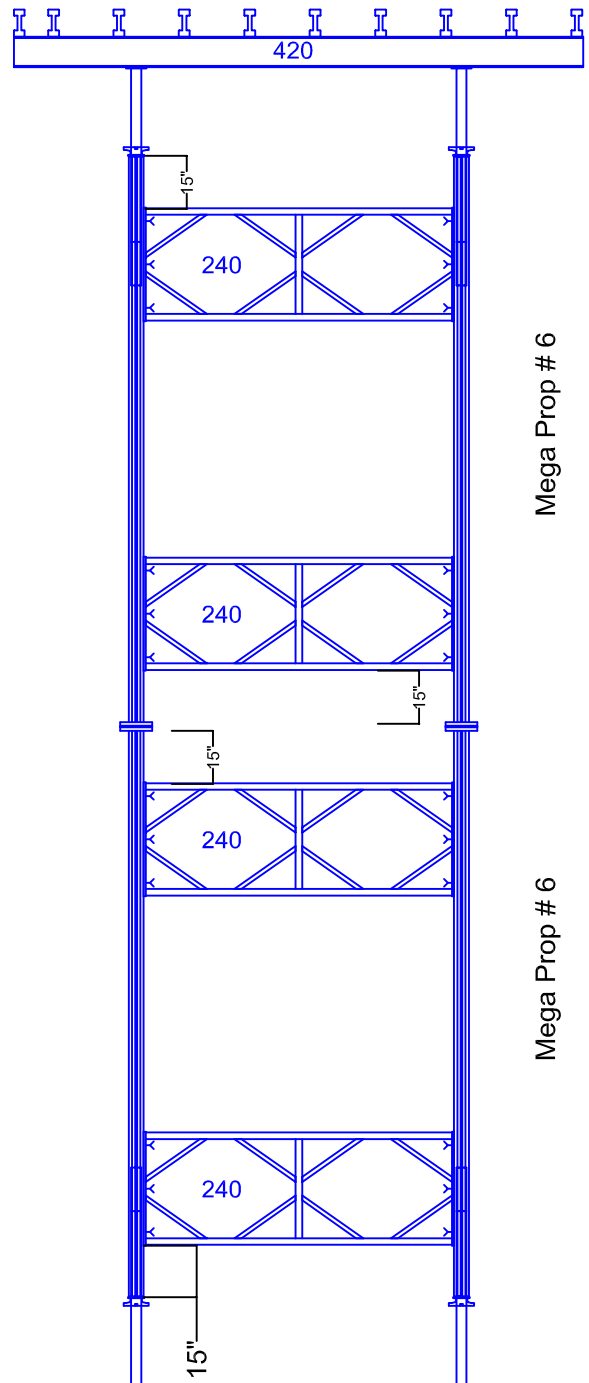

Mega Prop # 6

Mega Prop # 6



48575 Downing Street
Wixom, MI 48393

800.876.4857

info@formtechinc.com
formtechinc.com



Give us a call at any of our branch locations, email us at info@formtechinc.com, or click on formtechinc.com/quote to get a quote. Our experienced Form Tech representatives will answer your questions, and help you get your project started with some of the best concrete forming, shoring, and accessory products in the industry, backed by a professional and detail-oriented staff.



Charleston, SC

7377 Peppermill Lane
North Charleston,
SC 29418
843.628.3434



Detroit, MI

Corporate Headquarters
975 Ladd Road
Walled Lake,
MI 48390
Branch: 248.344.8260
Corporate: 248.344.8265



Charleston, WV

161 Industrial Road
St. Albans,
WV 25177
304.722.6804



Pittsburgh, PA

2850-A Kramer Road
Gibsonia,
PA 15044
412.331.4500



Charlotte, NC

1000 Thomasboro Road
Charlotte,
NC 28208
704.395.9910



Raleigh, NC

115 Peffinder Lane
Raleigh,
NC 27603
919.833.0911



Cleveland, OH

20801 Miles Road
North Randall,
OH 44128
216.692.0497



TRUSTED FORMWORK & ACCESSORY SPECIALISTS

800-876-4857 | info@formtechinc.com | formtechinc.com